



27" Pro LED Monitor WQHD



CONTENTS

SAFETY WARNINGS AND GUIDELINES.....	3
FEATURES	4
PACKAGE CONTENTS.....	4
CONNECTIONS.....	5
CONTROLS.....	6
SETUP.....	7
MONITOR STAND & BASE.....	7
VIEWING ANGLE ADJUSTMENT.....	9
MAIN INPUT SELECTION.....	9
ON-SCREEN DISPLAY (OSD) MENU	10
Basic Menu Operation.....	10
BRIGHTNESS MENU	11
IMAGE MENU.....	12
COLOR TEMP MENU.....	13
OSD SETTING MENU	14
RESET MENU	15
MISC MENU	16
TECHNICAL SUPPORT	17
WARRANTY	17
TROUBLESHOOTING.....	18
SPECIFICATIONS.....	19
Compliance Information.....	20

SAFETY WARNINGS AND GUIDELINES

- Do not place the monitor on an unstable surface where it could fall and cause either personal injury or damage to the monitor and/or other equipment.
- Do not expose the monitor to water or moisture of any kind. Do not place objects containing moisture, such as a glass or vase, where it could tip over and spill into or onto the monitor.
- If the monitor is exposed to water or moisture, immediately unplug it from its power source and allow it to completely dry out before reapplying power.
- Do not block the ventilation holes in the monitor's casing. Do not place the monitor in a confined space with inadequate ventilation.
- Do not place the monitor near a heat source, such as a fireplace, heating vent, radiator, etc.
- The power supply for this monitor uses a NEMA 5-15 three prong, grounded plug. Do not use a "cheater" plug or otherwise bypass the grounding pin.
- The power supply for this monitor accepts a wide range input voltages, from 100 to 240 VAC, 50 or 60 Hz, with a current at least 1.75A. Ensure that your power source is within these limits. If not, consult a professional electrician or your power company for a resolution.
- Unplug the monitor if it will go unused for a long period of time.
- This monitor has no user serviceable parts. Do not open the case or otherwise attempt to modify this monitor.
- Clean only using a soft, dry cloth. Do not use chemical cleaners, solvents, or detergents. For stubborn deposits, moisten the cloth with warm water.
- Do not leave a single image on the display for a long period of time. Doing so could cause "burn-in" of the image. It is recommended to use a variable desktop background and to use a screen saver to prevent "burn-in". Alternatively, ensure that the monitor is power off for at least 2 hours out of every 12.

FEATURES

- 27" WQHD monitor with LED backlighting
- 16:9 aspect ratio
- 2560 x 1440 @ 60Hz maximum resolution
- 1 DisplayPort input
- 1 HDMI input
- 1 Dual Link DVI-D input
- 1 VGA input
- Detachable stand allows for tilt and swivel, plus rotation for easy portrait/landscape orientation changes
- Built-in stereo speakers with 2 watts/channel amplifier
- 100 x 100 VESA mounting pattern

PACKAGE CONTENTS

Please take an inventory of the package contents to ensure you have all the items listed below. If anything is missing or damaged, please contact Monoprice Customer Service for a replacement.

- 1x 27" WQHD LED monitor
- 1x Adjustable stand
- 1x Stand base
- 4x M4x8 stand mount screws
- 1x AC power adapter
- 1x AC power cord
- 1x 3.5mm TRS audio cable
- 1x Dual Link DVI-D video cable
- 1x User's manual

CONNECTIONS

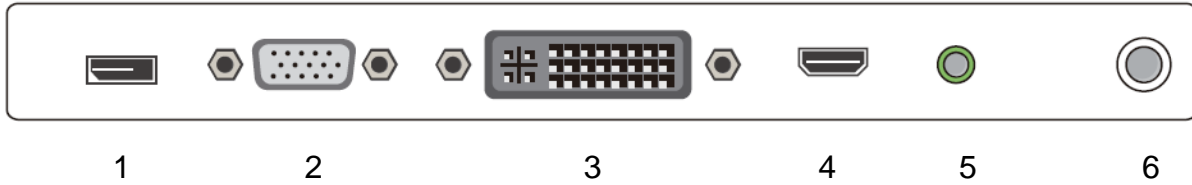

1	DP	DisplayPort 1.2 video input
2	VGA	Analog D-Sub video input
3	DVI	Dual Link DVI-D video input
4	HDMI	HDMI video input
5	Line In	3.5mm TRS stereo audio input
6	DC In	DC power input

DVI Note: This monitor features a Dual Link DVI-D input port. Your DVI source must support Dual Link DVI-D and you must use a Dual Link DVI-D cable (included), which has a pinout that looks like this:



CONTROLS

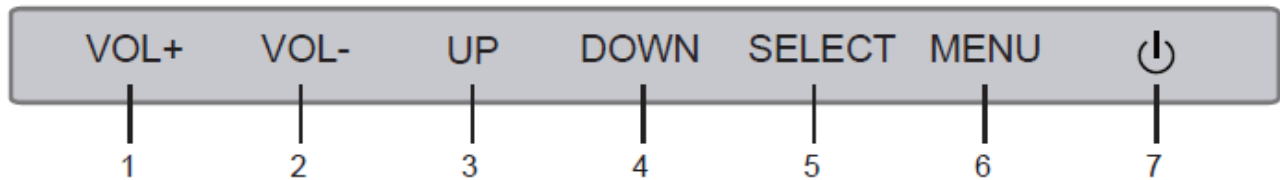

1. **VOL+:** If the OSD menu is displayed and an entry has been opened for editing, pressing the VOL+ button increases the selected value. If the OSD is not displayed, pressing the VOL+ button opens the volume adjustment control. With either the brightness or volume adjustment control displayed, pressing the VOL+ button increases the brightness or volume.
2. **VOL-:** If the OSD menu is displayed and an entry has been opened for editing, pressing the VOL- button decreases the selected value. If the OSD is not displayed, pressing the VOL- button opens the brightness adjustment control. With either the brightness or volume adjustment control displayed, pressing the VOL- button decreases the brightness or volume.
3. **UP:** If the OSD menu is displayed, pressing the UP button moves the selection highlight up. If the OSD menu is not displayed, the button is ECO function hotkey.
4. **DOWN:** If the OSD menu is displayed, pressing the DOWN button moves the selection highlight down. If the OSD menu is not displayed, the button is DCR function hotkey.
5. **SELECT:** If the OSD menu is displayed, pressing the SELECT button enters the OSD highlighted entry. If the OSD menu is not displayed, the button displays the source list.
6. **MENU:** If the OSD menu is not displayed, pressing the MENU button opens the OSD menu. If the OSD menu is displayed pressing the MENU button will back out of a submenu or close the OSD menu if already at the top menu level.
7. **POWER:** Press the POWER button to toggle the monitor ON or OFF. When the monitor is powered on and a video signal is present, the power indicator will glow blue. When the monitor is powered on but no video signal is present, the power indicator will glow yellow/orange.

SETUP

1. Install the stand and base, using the instructions in the following section, or mount the monitor to a wall or desk mount using the included M4x8 screws.
2. Connect video cable(s) from your source device(s) to the monitor's input(s). The monitor has 4 video inputs (1x DVI, 1x HDMI, 1x DisplayPort, 1x VGA) and can simultaneously display up to four video sources.
3. Use the included 3.5mm TRS audio cable to connect the audio output of your computer to the audio input on the monitor.
4. Plug the DC power connector on the AC power adapter into the DC IN port on the back of the monitor.
5. Plug the included AC power cord into the AC power adapter. Plug the other end into a nearby power outlet.

MONITOR STAND & BASE

To install the stand, perform the following steps:

1. Place a blanket or towel on a flat surface, such as a table or the floor.
2. Place the monitor face down on the blanket or towel.
3. Install the stand on the VESA mount using the four included M4x8 screws.
4. Fit the base on the bottom of the stand and press it until it clicks into place.

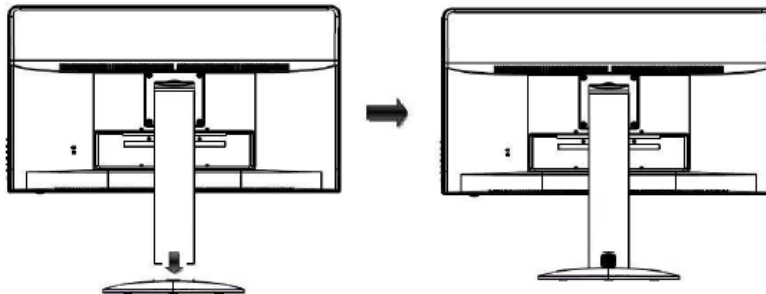

To remove the base, perform the following steps:

1. Place a blanket or towel on a flat surface, such as a table or the floor.
2. Place the monitor face down on the blanket or towel.
3. Squeeze the plastic clip on the bottom of the base and pull the base off the stand.

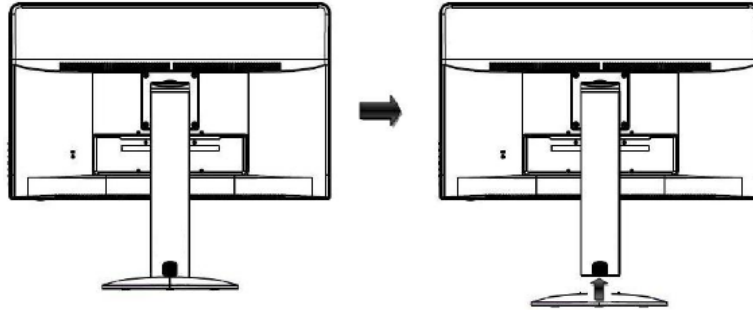

Note that the stand can be removed from the back of the monitor so that the monitor can be attached to a desk or wall mount. To remove the stand, perform the following steps:

1. Place a blanket or towel on a flat surface, such as a table or the floor.
2. Place the monitor face down on the blanket or towel.
3. Remove the four M4x8 screws attaching the stand to the back of the monitor.
4. Follow the mounting instructions for your wall/desk mount to attach the monitor to the mount.
5. Store the stand and mount screws in a safe place for future use.

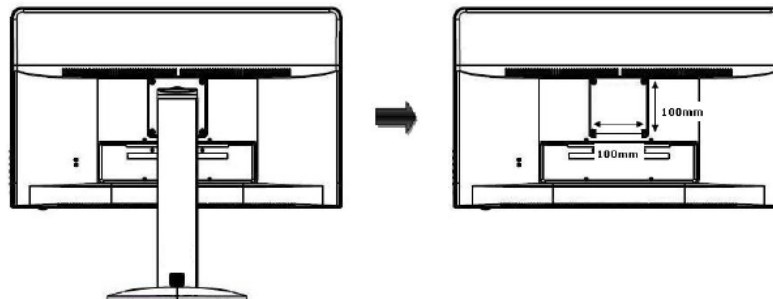

Note: The monitor uses a VESA mounting size of 100x100mm.

VIEWING ANGLE ADJUSTMENT

The included monitor stand supports tilt adjustment from -5° (down) to $+20^{\circ}$ (up). To adjust the angle, grasp the bezel at both the top and bottom of the monitor and move it as desired. Use soft cloth gloves or a soft, dry cloth to grasp the monitor without touching the screen.

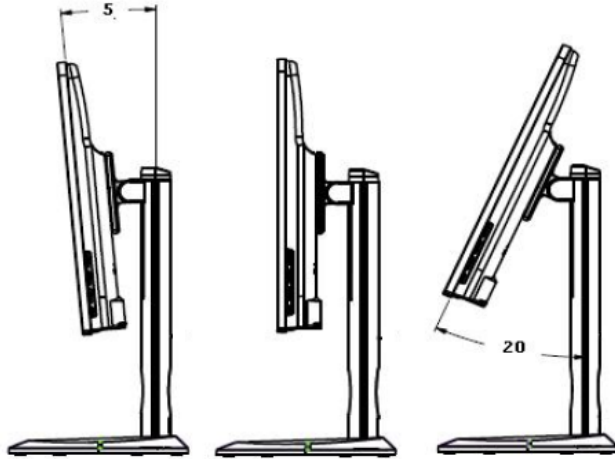

MAIN INPUT SELECTION

To change the main input, perform the following steps:

1. Press the SELECT button to display the Input Selection menu.
2. Use the UP or DOWN buttons to move the highlight to the desired input.
3. Press the SELECT button to select the highlighted input.



ON-SCREEN DISPLAY (OSD) MENU

Press the MENU button to access the OSD menu.

Basic Menu Operation

VOL+: When the OSD menu is displayed and an item has been opened for editing, pressing the VOL+ button increases the selected value.

VOL-: When the OSD menu is displayed and an item has been opened for editing, pressing the VOL- button decreases the selected value.

UP: When the OSD menu is displayed, pressing the UP button moves the selection highlight up.

DOWN: When the OSD menu is displayed, pressing the DOWN button moves the selection highlight down.

SELECT: When the OSD menu is displayed, pressing the SELECT button either selects the currently highlighted menu option or opens the currently highlighted menu entry for editing. If the OSD menu is not displayed, pressing the SELECT button opens the INPUT SELECTION menu and selects the currently highlighted video input.

MENU: If the OSD menu is not displayed, pressing the MENU button opens the OSD menu. When the OSD menu is displayed pressing the MENU button will back out of a submenu or close the OSD menu if already at the top menu level.

BRIGHTNESS MENU



BRIGHTNESS: Adjusts the image brightness. The adjustment range is 0 to 100.

CONTRAST: Adjusts the image contrast. The adjustment range is 0 to 100.

ECO: Preset display mode selection. Four display modes: Standard, Text, Movie, Game

DCR: DCR stands for Dynamic Contrast Ratio, which is a circuit that increases the effective picture contrast by changing the light intensity of the LED backlighting. DCR tends to cause too much contrast fluctuation when dealing with swiftly moving images and is usually better suited to applications use than for use with games. DCR can be turned On or Off.

IMAGE MENU

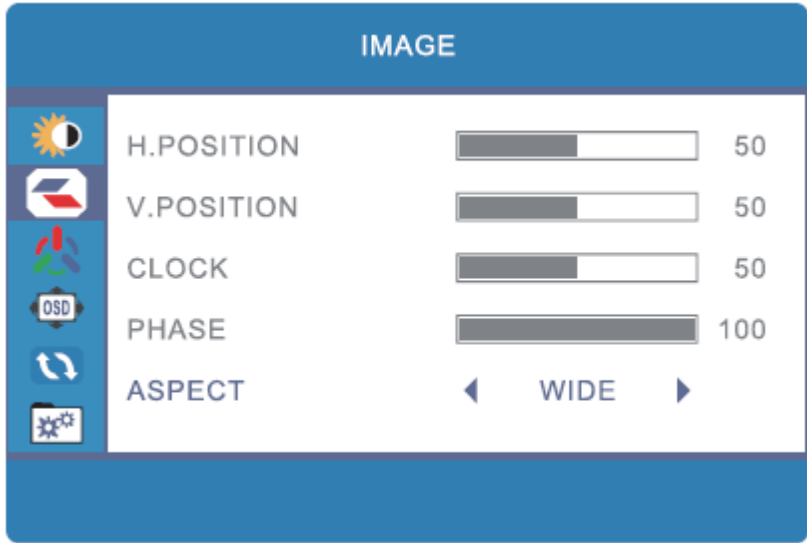

H. POSITION: Adjusts the horizontal position of the image. The adjusting range is from **0** to **100**. (Only available for VGA input.)

V. POSITION: Adjusts the vertical position of the image. The adjusting range is from **0** to **100**. (Only available for VGA input.)

CLOCK: Adjusts the clock frequency. The adjusting range is from **0** to **100**. (Only available for VGA input.)

PHASE: Reduces image noise by adjusting Phase. The adjusting range is from **0** to **100**. (Only available for VGA input.)”

ASPECT: Adjusts the aspect ratio to “**WIDE**” or “**4:3**”

COLOR TEMP MENU

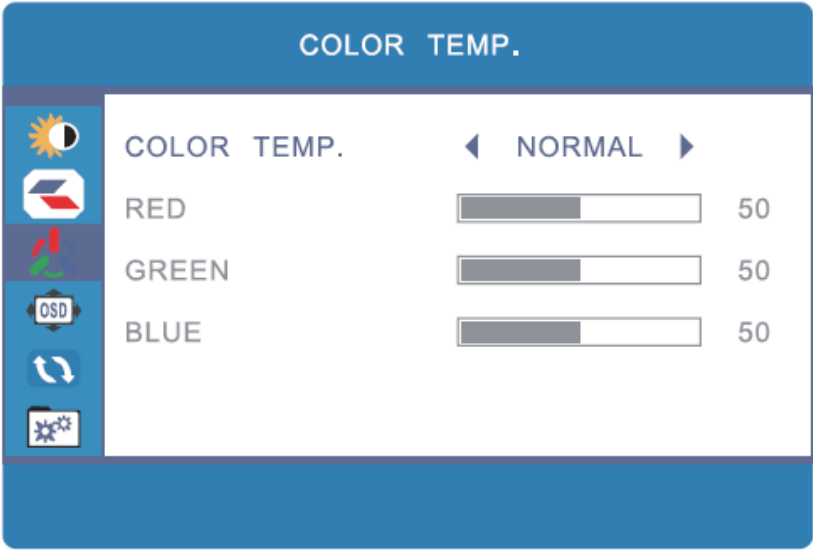

COLOR TEMP.: Contains four color modes: “Warm”, “Normal”, “Cool”, and “User”

RED: The color of Red is user-configurable; the adjusting range is from 0 to 100.

GREEN: The color of Green is user-configurable; the adjusting range is from 0 to 100.

BLUE: The color of Blue is user-configurable; the adjusting range is from 0 to 100.

OSD SETTING MENU

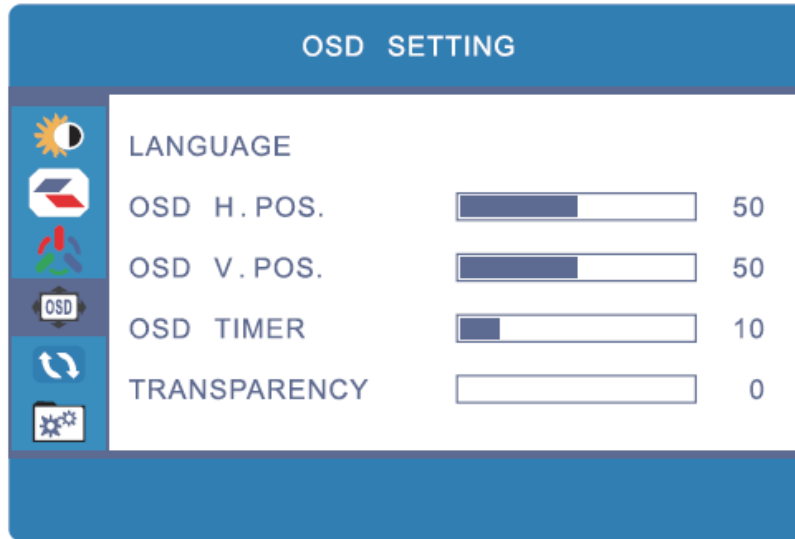

LANGUAGE: This menu allows you to set the language to be used in the OSD. The possible options are English, French, Deutsche, Italiano, Espanol, Nederlands.

OSD H. POS.: Adjusts the horizontal position of the OSD menu. The adjustment range is 0 to 100

OSD V. POS.: Adjusts the vertical position of the OSD menu. The adjustment range is 0 to 100

OSD Timer: Sets the amount of time in seconds that the OSD menu will display without any input before it automatically closes. The possible options are 5s, 10s, 15, 20s, 25s, 30s, 35s, 40s, 45s, 50s, 55s and 60s.

TRANSPARENCY: Adjusts how transparent or opaque the OSD menu will appear on screen. The possible options are 0, 25, 50, 75, and 100.

RESET MENU

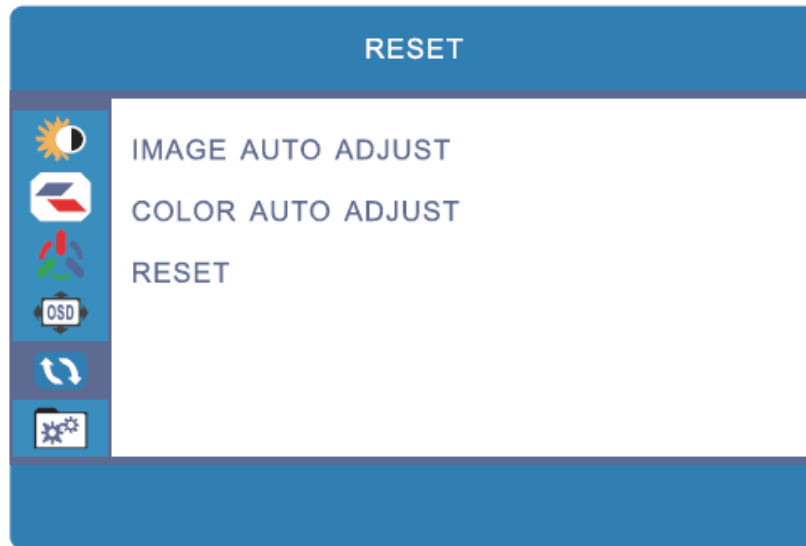
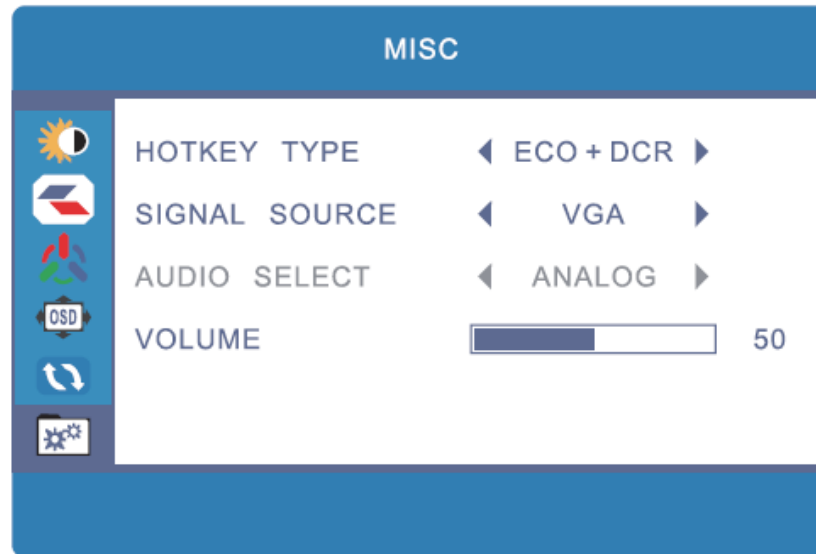

IMAGE AUTO ADJUST: Adjusts H/V Position and Clock/Phase automatically. (Only available for VGA input.)

COLOR AUTO ADJUST: Adjusts red, green, and blue colors gain automatically. (Only available for VGA input.)

RESET: Resets the display to its default values.

MISC MENU



HOTKEY TYPE: Contains **ECO+DCR**, **BRI+CON** and **ASP+ECO** hotkey combinations. (UP and DOWN will be the hotkey buttons while OSD menu is not displayed)

SIGNAL SOURCE: Selects the input source. You can select VGA, DVI, HDMI and DP.

AUDIO SELECT: Selects the audio input source (Analog or Digital).

VOLUME: Sets the volume level. The adjustment range is 0 to 100

TECHNICAL SUPPORT

Monoprice is pleased to provide free, live, online technical support to assist you with any questions you may have about installation, setup, troubleshooting, or product recommendations. If you ever need assistance with your new product, please come online to talk to one of our friendly and knowledgeable Tech Support Associates. Technical support is available through the online chat button on our website (www.monoprice.com) during regular business hours, 7 days a week. You can also get assistance through email by sending a message to tech@monoprice.com.

WARRANTY

MONOPRICE will replace defective monitors with a new monitor if the RMA is issued within thirty (30) days of the original date of purchase, as shown on the original invoice. Monitors identified as defective after 30 days, but within the twelve (12) month warranty period, will be replaced with refurbished, reconditioned, or used monitors at MONOPRICE'S discretion. All returned products are the property of MONOPRICE and must be returned to MONOPRICE for a replacement to be issued.

TROUBLESHOOTING

Following are some common problems and possible solutions. If you cannot solve a problem yourself, please contact Monoprice Technical Support for assistance.

Q: The power LED is off.

A: Verify that the power adapter is plugged into the monitor. Verify that the power cord is plugged into both the AC adapter and the power outlet. Verify that the power outlet is live by plugging something else into it, such as a lamp.

Q: The picture is weak, washed out, or over saturated.

A: Adjust the Brightness and/or Contrast.

Q: The image flashes or distorts.

A: Verify that there are no nearby sources or Radio Frequency or Electromagnetic Interference (RFI or EMI).

Q: The power LED is glowing blue, but the display is blank.

A: Press a key on the keyboard to ensure the computer is not asleep or that a screen saver is active. Verify that the proper input is selected. Verify that the display cable is securely attached to both the display and the video source. Replace the cable with another of the same type to verify that it is not faulty.

Q: One of the primary colors (red, green, or blue) is missing.

A: Replace the video cable with another of the same type. Connect to a different video source to verify that there are no problems with the video card or source device.

Q: The colors are not correct.

A: Adjust the color temperature or the individual mix of red, green, and blue picture elements.

Q: No picture using the DVI input.

A: Verify that you are using a Dual Link DVI-D cable. Verify that your video card is capable of delivering a Dual Link DVI-D signal. A Dual Link DVI-D cable will have a pinout that looks like this:



SPECIFICATIONS

Display Type	AH-IPS panel with LED backlight
Screen Size	27" (685mm)
Dot Pitch	0.2331 x 0.2331 mm
Maximum Resolution	2560 x 1440 @ 60Hz (WQHD)
Brightness	350cd/m ²
Viewing Angle	178° left/right, 178° up/down
Video Inputs	1x Dual Link DVI-D, 1x DisplayPort v1.2, 1x HDMI, 1x VGA
Audio Inputs	1x 3.5mm TRS Line In
Horizontal Frequency (HFR)	30 ~ 158 kHz
Vertical Frequency (VFR)	60 ~ 75Hz
Pixel Clock Frequency	300 MHz
PNP Standard	VESA DDC2BTM
Power Consumption	Operation: < 50W Standby: < 1W
Monitor Input Power	12 VDC, 5.42A
AC Adapter Input Power	100 ~ 240 VAC, 50-60 Hz
Operating Temperature	+32 ~ +122°F (0 ~ +50°C)
Storage Temperature	-4 ~ +140°F (-20 ~ +60°C)
Operating Humidity	10 ~ 85%, non-condensing
VESA Mount Size	100 x 100
Dimensions	25.8" x 9.6" x 21.7" (658 x 245 x 552 mm)
Weight	16.7 lbs. (7.6 kg)
Certifications	ETL, FCC, CE

Compliance Information

FCC Class B Notice

Note: This equipment has been tested and found to comply with the limits for a Class B digital device, pursuant to Part 15 of the FCC Rules. These limits are designed to provide reasonable protection against harmful interference in a residential installation. This equipment generates, uses and can radiate radio frequency energy and, if not installed and used in accordance with the instructions, may cause harmful interference to radio communications. However, there is no guarantee that interference will not occur in a particular installation. If this equipment does cause harmful interference to radio or television reception, which can be determined by turning the equipment off and on, the user is encouraged to try to correct the interference by one or more of the following measures:

- Reorient or relocate the receiving antenna.
- Increase the separation between the equipment and receiver.
- Connect the equipment into an outlet on a circuit different from that to which the receiver is connected.
- Consult the dealer or an experienced radio/television technician for help.

Modifications: Any modifications made to this device that are not approved by Monoprice, Inc. may void the authority granted to the user by the FCC to operate this equipment.

CE Compliance Statement:

This product is in compliance with CE directives and bears the CE mark. For detailed information on specific directives please contact Customer Service or sales office or distributor.

WEEE Directive Compliance Statement:



This symbol on the product or on its packaging indicates that the product must not be disposed of with normal household waste. Instead, it is your responsibility to dispose of your waste equipment by arranging to return it to a designated collection point for the recycling of waste electrical and electronic equipment. By separating and recycling your waste equipment at the time of disposal you will help to conserve natural resources and ensure that the equipment is recycled in a manner that protects human health and the environment.

ETL Compliance Statement:

This product has been thoroughly tested by Intertek – ETL, a nationally recognized independent third-party testing laboratory. The North American ETL Listed mark signifies that the device has been tested to and has met the requirements of a widely recognized consensus of U.S. and Canadian device safety standards, that the manufacturing site has been audited, and that the manufacturer has agreed to a program of quarterly factory follow-up inspections to verify continued conformance.