

Instruction / Installation Sheet

DataComm Electronics 45-0081 Recessed Low Voltage Mid-Size Plate with Duplex Surge Suppressor



DataComm Electronics, Inc.
6349 Peachtree Street
Norcross, GA 30071-1725
888.223.7977
770.662.8205
www.datacommelectronics.com

Parts Included:

1. 45-0081 Recessed Low Voltage Mid-Size Plate
2. Electrical Outlet Box
3. 15 Amp/125 Volt Duplex Surge Suppressor
4. Four (4) Screws

Tools Needed:

1. Drywall Saw
2. 6 Ft. Tape Measure
3. Pencil
4. Screwdriver

Use DataComm Electronics' Recessed Low Voltage Mid-Size Plate with Duplex Surge Suppressor to install low voltage cables behind your flat panel TV, your amplifier or other audio and video devices. This mid-size plate can be installed upright, sideways.

Features of the 45-0081 Recessed Low Voltage Mid-Size Plate with Duplex Surge Suppressor include:

- Compact size fits behind small and large TV's
- TV plug recesses completely into the wall
- Duplex receptacle for additional devices
- Low voltage flexible screen cover conceals opening in the low voltage portion of the wall plate

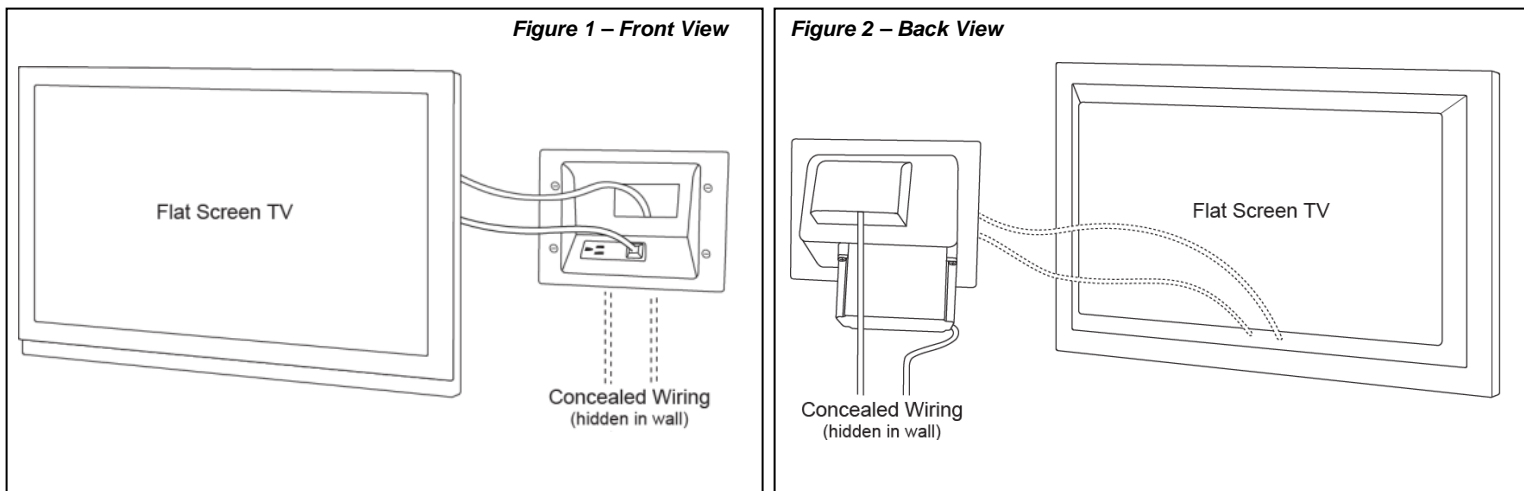

IMPORTANT INSTRUCTIONS:

This product is designed for retrofit work only because the electrical outlet box cannot be attached to a stud.

This product is designed to alert you if you ever lose surge protection. The Surge Suppressor Receptacle is designed to provide protection against short-term over-voltage conditions as well as from RFI (radio frequency interference). The Surge Suppressor cannot survive, or provide protection in the rare event of a direct lightning strike on the service power line. The Surge Suppressor alerts you to the failure of the surge protection component by means of an audible signal. If alarm sounds, device has "received" power surges in excess of its capacity and is no longer functioning as a surge protector. To shut off alarm, simply turn the "Alarm Off" screw on the front of the receptacle clockwise. Note: When alarm sounds and the "Alarm Off" screw is turned off, the receptacle still functions as a normal duplex receptacle without surge protection.

WARNING:

Before you run your 12/2 or 14/2 w/ground UL approved building wire to the Recessed Low Voltage Mid-Size Plate with Duplex Surge Suppressor, be sure the power is off by switching the circuit breaker to off or removing the fuse(s). Test the power to make sure the power is off. Be sure to install the Mid-Size Plate with Duplex Surge Suppressor in accordance with the National Electrical Code (NEC) and local codes.

Installation Instructions:



Figure 1

Top view - shows needed space between the drywall and the studs. Receptacle side of the Mid-Size Plate should be 3" from the stud but no more than 5" (review picture carefully).

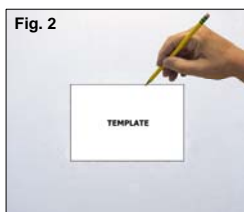

Figure 2

Using the template supplied (see page 3 of instruction sheet), trace the opening needed. Using a drywall saw, cut a hole in the drywall the size of the template. **See Figure 1** before tracing your opening. **Remember, the plates are designed to be mounted between the studs.**

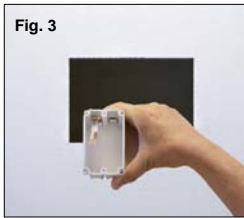

Figure 3
 Run the source of power to the included electrical outlet box.

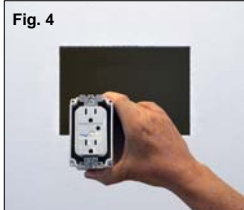

Figure 4
 Using the supplied Duplex Surge Suppressor, connect the Recessed Mid-Size Plate to the piece of 12/2 or 14/2 with ground UL approved electrical building wire that you have pulled from a power source. Strip off approximately 3 inches of the outer jacket of the UL approved building wire. Be careful not to cut the jacket of the inner wires. Connect the hot line (black) wire to the brass colored terminal screw and neutral (white) wire to the silver colored terminal screw. Be sure to connect the grounding (green) or bare grounding wire to the green colored terminal screw (*see Fig 3*). Once you have wired the supplied Duplex Surge Suppressor, screw the Duplex Surge Suppressor receptacle into the electrical outlet box until the receptacle is firmly secured.

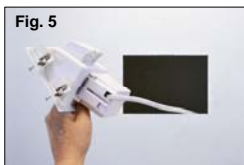

Figure 5
 Now use the four screws provided to secure the electrical outlet box to the mounting studs on the backside of the Mid-Size Plate.

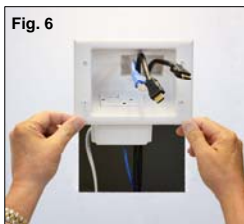

Figure 6
Important: Before installing the Recessed Mid-Size Plate with Duplex Receptacle into the template opening, make sure to pull your low voltage cables through the low voltage cable opening. If you have more than 4 cables you can remove the flexible plate that seals the low voltage cable opening. This allows for more cables to be pulled through the opening.
After you have pulled your low voltage or A/V cables through the low voltage opening: Start with the bottom of the Recessed Mid-Size Plate and slowly slide the plate into the opening. Swing the top of the plate into position until the entire Mid-Size Plate is flush with the wall. Now screw down the screws with wings; these wings fasten tightly against the back of the drywall.

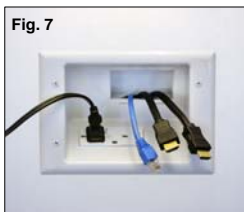

Figure 7
 Your new 45-0081-WH Recessed Low Voltage Mid-Size Plate with Duplex Surge Suppressor is now installed and ready for the flat panel TV mount to be installed. Install your flat panel TV mounting bracket per the flat panel TV bracket manufacturer's instructions.

Surge Suppressor Specifications

Inside the Hubbell Surge Protection Receptacles are two 22mm square MOV's providing 240 joules /15000A of surge protection for each mode. Meets UL Standards 1449 3rd Edition and 498: CSA Certified.

Damage-alert alarm sounds when surge protection is no longer functioning and keeps sounding until the muting screw is utilized or the receptacle is replaced. Power-on indicator light verifies instantly that power is available at the receptacle and the suppression circuit is fully functional; light off means power has been interrupted, flashing light indicates surge protections circuitry has been damaged.

Replacement surge suppressor can be purchased from DataComm Electronics or an authorized Hubbell Wiring Device distributor.

2-Pole 3-Wire Grounded 60 Hz	Total Maximum Surge Dissipation	Maximum Surge Current	Surge Protection	Clamping Response Time
15A-125V	480 Joules	15,000 Amps	Hot/Neutral, Hot/Ground, Neutral/Ground	1 Nanosecond

WARNING

- DataComm Electronics' products shall be installed and used only as indicated in DataComm Electronics' product instruction sheets.
- Instruction sheets are available online at www.datacommelectronics.com.

CAUTION

- For shock protection, this device must be properly grounded.
- Use copper wire only with this device.

IMPORTANT INSTRUCTIONS

- Read and understand all instructions.
- Follow all warnings and instructions marked on the product.
- Do not use this product near water, for example near a bath tub, wash bowl, kitchen sink, laundry tub, in a wet basement, or near a swimming pool.
- **SAVE THESE INSTRUCTIONS.**

ONLY LICENSED PROFESSIONALS SHOULD INSTALL THIS PRODUCT

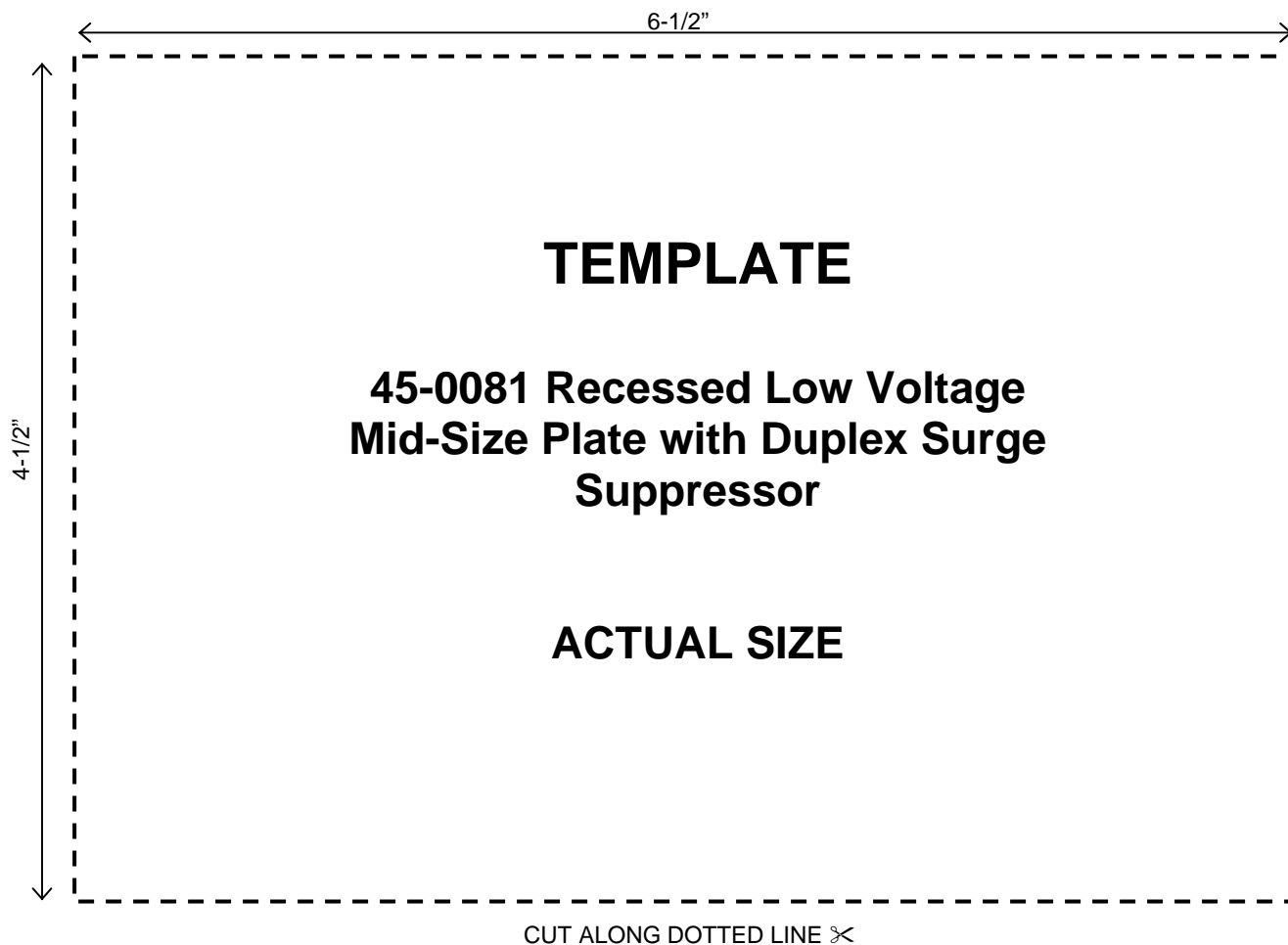

This product is patent protected by U.S. Patent numbers D553475, D554475 and 7390964.
RoHS Compliant.

