



Wireless Smart Water Leak/Flood Sensor

P/N 33124

User's Manual

CONTENTS

- INTRODUCTION..... 3
- FEATURES..... 3
- CUSTOMER SERVICE..... 3
- PACKAGE CONTENTS 4
- PRODUCT OVERVIEW 5
- PHYSICAL INSTALLATION..... 5
- APP INSTALLATION AND LOGIN 6
- ADD A DEVICE 7
 - Smart Inclusion Installation 7
 - AP Mode Installation..... 10
- APP FEATURES..... 12
- LED INDICATOR STATUS 13
- TECHNICAL SUPPORT 13
- SPECIFICATIONS..... 14
- REGULATORY COMPLIANCE..... 15
 - Notice for FCC 15
 - RF Exposure Statement for FCC..... 15
 - Notice for Industry Canada..... 15
 - Radio Notice for Industry Canada..... 16
 - RF Exposure Statement for Industry Canada 16

INTRODUCTION

This Wireless Smart Water Leak/Flood Sensor allows you to remotely monitor your home using your Android™ or iOS® smartphone or tablet. The sensor communicates with your phone through your local Wi-Fi® network, so you won't need any separate mesh network hubs or controllers. Be the first to receive instant notifications to your phone whenever a leak is detected.

FEATURES

- Provides simple 24/7 remote monitoring of your home water system
- Set push notifications to your mobile devices and be alerted whenever a leak is detected
- Reports battery level and logs events
- Detachable probe provides extension to tight or hard to reach areas
- Supports scene control and works with other "smart" devices
- Works with STITCH by Monoprice smart devices (sold separately)

CUSTOMER SERVICE

The Monoprice Customer Service department is dedicated to ensuring that your ordering, purchasing, and delivery experience is second to none. If you have any problem with your order, please give us an opportunity to make it right. You can contact a Monoprice Customer Service representative through the Live Chat link on our website www.monoprice.com during normal business hours (Mon-Fri: 5am-7pm PT, Sat-Sun: 9am-6pm PT) or via email at support@monoprice.com

PACKAGE CONTENTS

Please take an inventory of the package contents to ensure you have all the items listed below. If anything is missing or damaged, please contact Monoprice Customer Service for a replacement.

1x Water/Flood Sensor

1x Mounting Bracket

1x Probe

1x User's Manual

APPLICATIONS

Place the device under sinks, near bathtubs, water heaters, pipes, filters, and anywhere a leak may be present.



BATHTUB



TOILET



SINK



WATER HEATER



WASHING MACHINE



PLUMBING

PRODUCT OVERVIEW

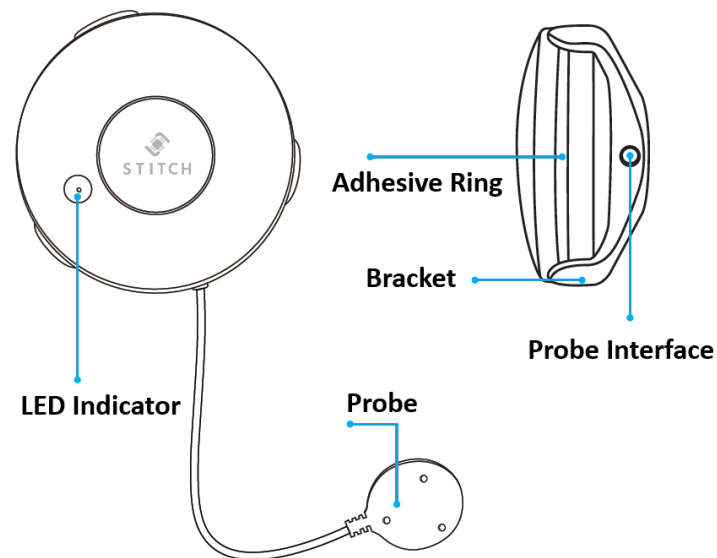

PHYSICAL INSTALLATION

1. Remove the bracket from the device and place the device directly in areas where a leak may be present. When water touches the metal sensors located at the bottom of the unit or on the probe, the device will beep.
2. Attach the bracket if you choose to mount the device at higher locations or on walls. When the bracket is attached to the device, connect the probe to the bracket for an extended reach.
3. Use the probe for extended reach in tight spaces or hard to reach areas.

APP INSTALLATION AND LOGIN

1. Download and install the free **STITCH by Monoprice** app from Google Play™ or the App Store. Scan one of the two QR codes below to go directly to the appropriate app store.



2. Once it has been installed, launch the app.
3. If you have already used the STITCH app, tap the Login button, then enter your STITCH account information. If you have not installed and used the STITCH app before, proceed to app registration. You can register using your phone number or by using your email address. Follow the on-screen app instructions for more details.

Note that the password must contain 6-20 characters and must include at least one number.

The screenshot shows the 'Login' screen of the STITCH app. At the top, there is a teal header with a back arrow and the word 'Login'. Below this, there are three input fields: 'Region' with a dropdown menu currently set to 'USA +1', 'Mobile Number/E-mail', and 'Password' with an eye icon to toggle visibility. A large grey 'Login' button is positioned below the input fields. At the bottom of the screen, there are two links: 'Sign in with SMS' on the left and 'Forgot Password' on the right.

ADD A DEVICE

Smart Inclusion Installation

Smart Inclusion is the default mode for installing your device. It uses your wireless network to communicate between your smartphone and the smart device. If you do not have a Wi-Fi® network or do not wish to include the sensor in your network, see the AP Mode Installation section.

1. Tap + on the **Add Devices** screen to add a new device.

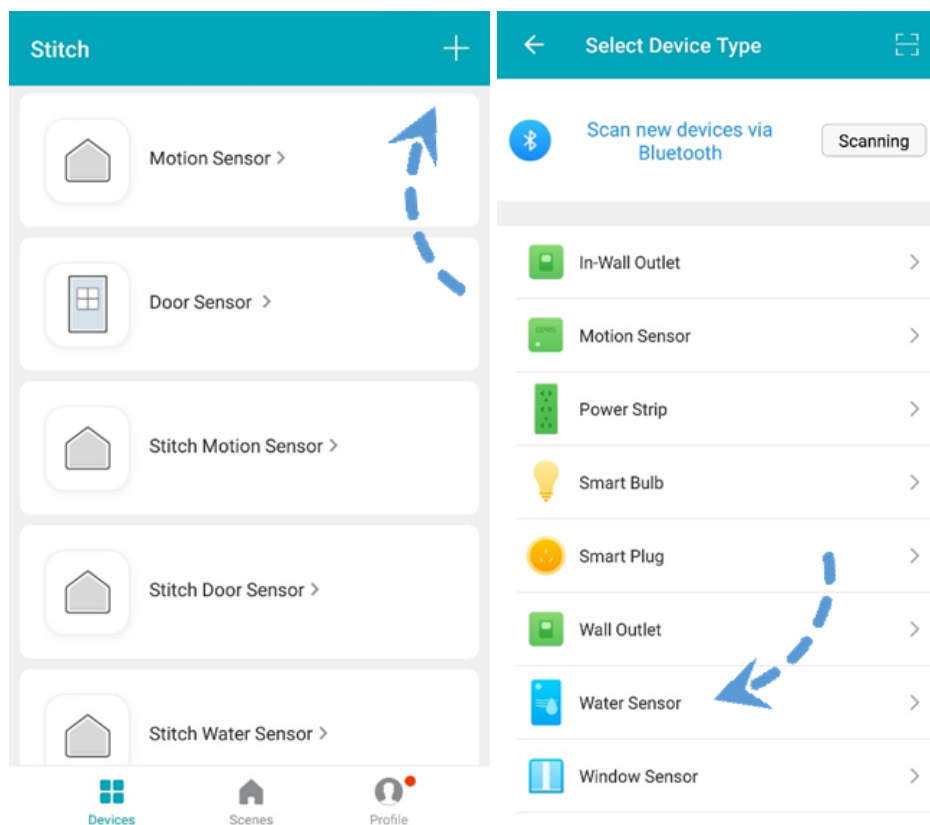

2. Scroll through the list and select **Water Sensor** to add your new device to the STITCH app.

3. The LED indicator should be flashing red rapidly, indicating that it is ready to be paired with your network. Tap **Confirm** on the app to continue, input the password to your wireless network, then tap **Confirm** again.

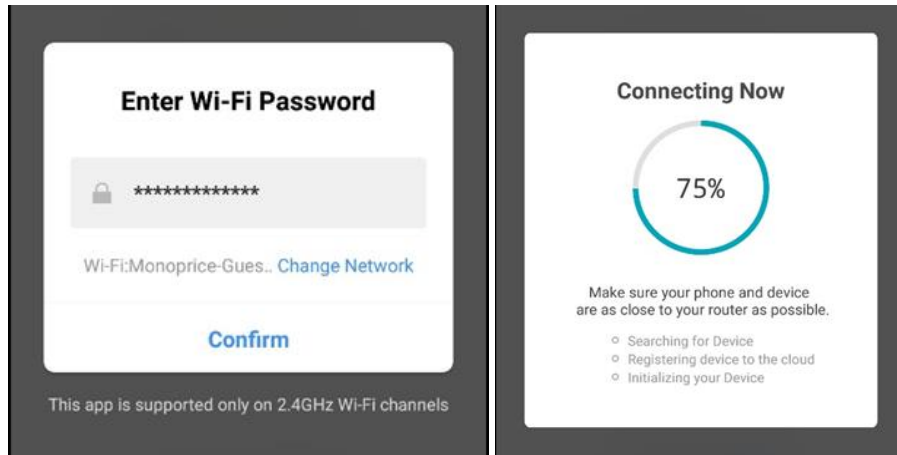

4. The app will start connecting to the device. Tap **Done** once it is completed.

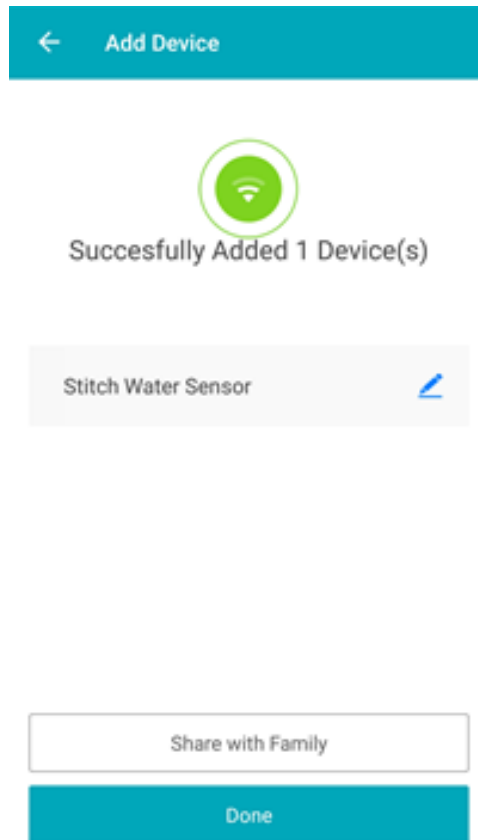

5. If the device is not flashing red rapidly, twist open the device cover and hold the **Reset** button for 5-6 seconds. The LED will flash red rapidly, indicating the device has been successfully reset.

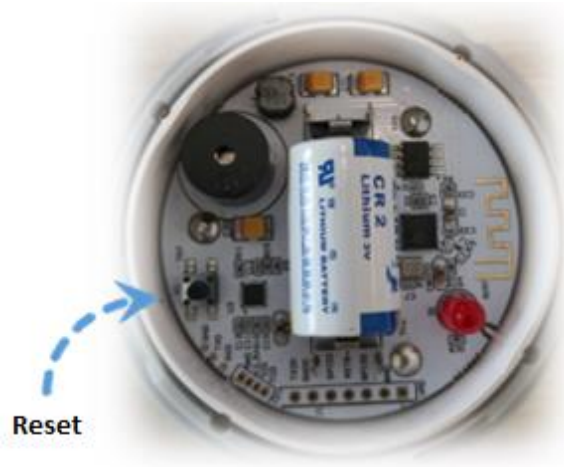

AP Mode Installation

AP mode differs from Smart Inclusion mode in that it does not use your Wi-Fi® network to manage the communications between your smartphone and the device. Instead, it connects your phone's Wi-Fi directly to the device's built-in hotspot network.

1. Launch the **STITCH by Monoprice** app.
2. Tap + on the **Add Devices** screen to add a new device.

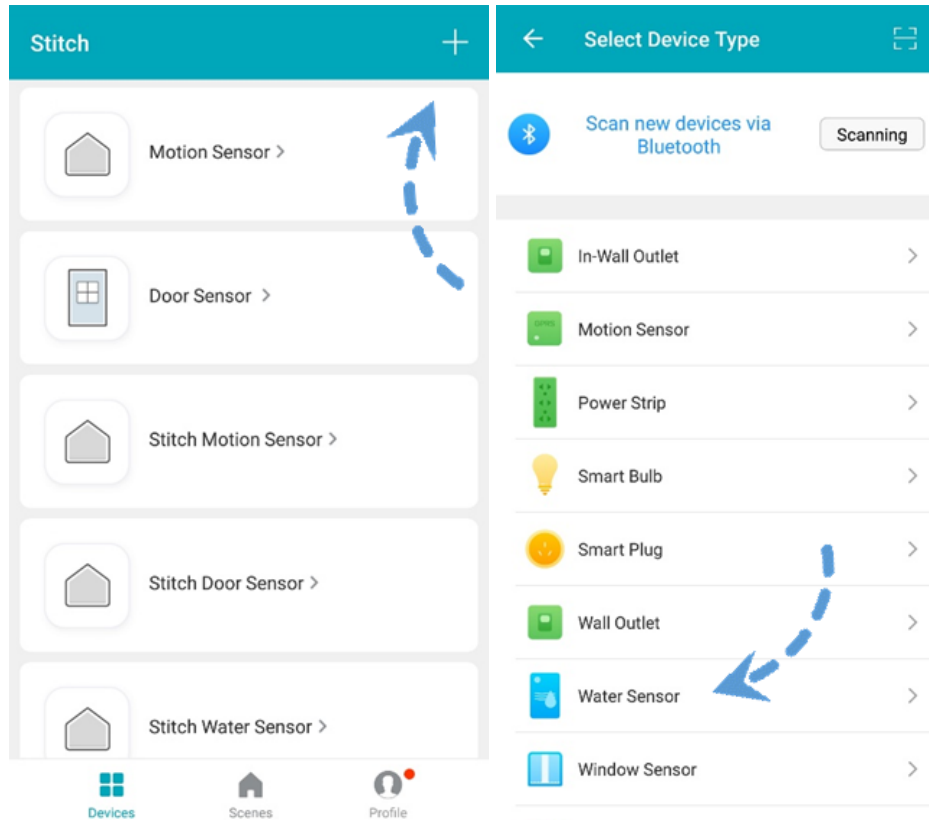

3. Scroll through the list and select **Water Sensor** to add your new device to the STITCH app.

4. Tap **AP Mode** at the top right.

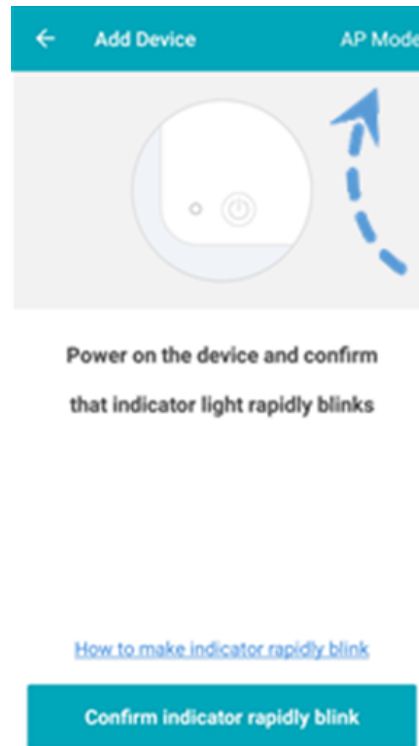

5. The LED should be slowly blinking, indicating that it is ready to be added in AP mode.
6. If it does begin blinking slowly, tap **Confirm** on the app to continue, input the password to your wireless network, then tap **Confirm** again.

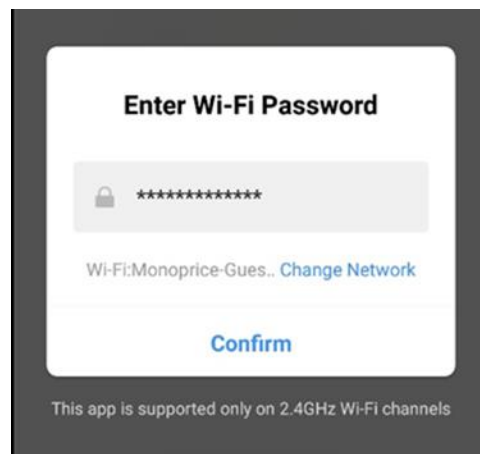

7. In the wireless settings, select the **Stitch-XXXX** entry, then tap **Connect Now** to continue. The app will begin connecting to the device.

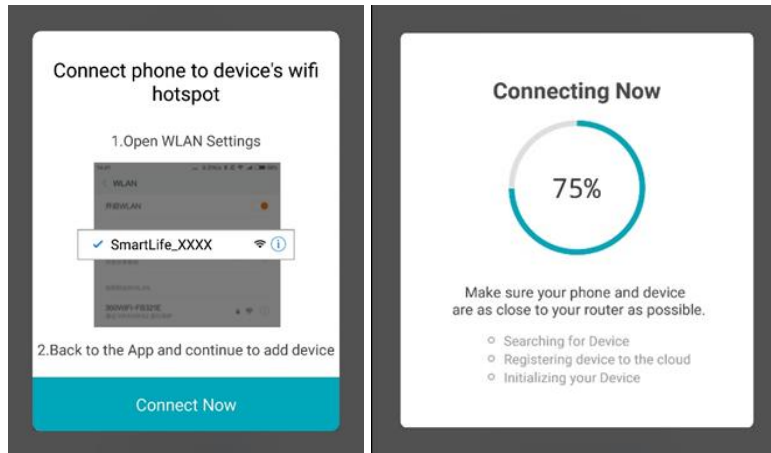

APP FEATURES

- Check battery level
- Review event history and logs
- Set device notifications

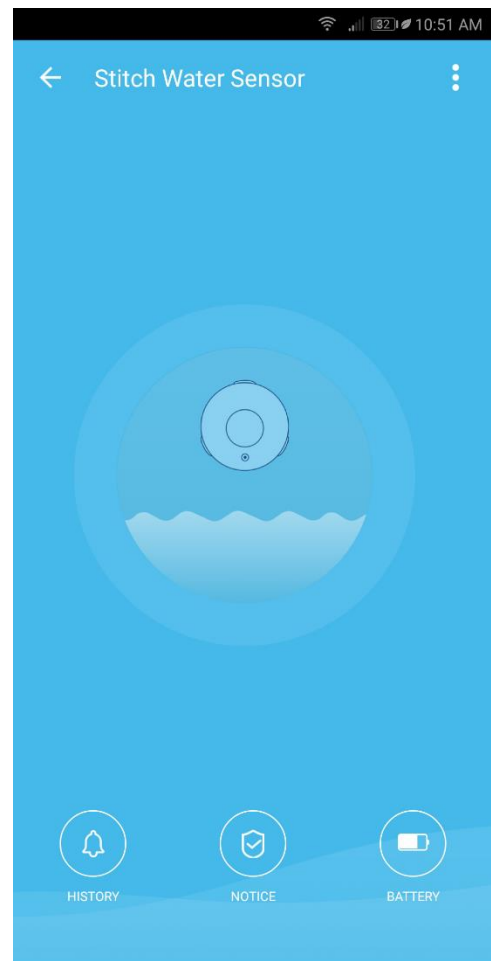

LED INDICATOR STATUS

LED Activity	Description
Rapidly flashing RED	Smart Inclusion Mode
Slowly flashing RED	AP Mode
LED flashes three time and the alarm rings three times, then the LED begins rapidly flashing after flashing once.	Alarm
LED is on for 4 seconds then turns off. After 3 seconds the LED will flash rapidly (first time reset) or flashes slowly (second time reset).	Reset

TECHNICAL SUPPORT

Monoprice is pleased to provide free, live, online technical support to assist you with any questions you may have about installation, setup, troubleshooting, or product recommendations. If you ever need assistance with your new product, please come online to talk to one of our friendly and knowledgeable Tech Support Associates. Technical support is available through the online chat button on our website www.monoprice.com during regular business hours, 7 days a week. You can also get assistance through email by sending a message to tech@monoprice.com

SPECIFICATIONS

Radio Frequency	2.4GHz
Supported Network Protocols	IEEE802.11 b/g/n
Wireless Range	Up to 147 feet (45m)
Power Source	1x CR2 battery
Standby Current	10 μ A
Battery Life	Up to 5 years in standby, up to 4 years when triggered twice each month
Ingress Rating	IP67
Buoyancy	Supported
Operating Temperature	+32 ~ +104°F (0 ~ +40°C)
Storage Temperature	+32 ~ +140°F (0 ~ +60°C)
Storage Humidity	0 ~ 90% RH, non-condensing
Sensor Dimensions	ø2.6" x 1.0" (ø67 x 24 mm)
Probe Length	About 3.8 feet (115.8 cm)

REGULATORY COMPLIANCE

Notice for FCC



Modifying the equipment without Monoprice's authorization may result in the equipment no longer complying with FCC requirements for Class A digital devices. In that event, your right to use the equipment may be limited by FCC regulations, and you may be required to correct any interference to radio or television communications at your own expense.

This equipment has been tested and found to comply with the limits for a Class A digital device, pursuant to Part 15 of the FCC Rules. These limits are designed to provide reasonable protection against harmful interference in a commercial installation. This equipment generates, uses and can radiate radio frequency energy and, if not installed and used in accordance with the instructions, may cause harmful interference to radio communications. Operation of this equipment in a residential area is likely to cause harmful interference, in which case the user will be required to correct the interference at his own expense.

RF Exposure Statement for FCC

Caution 

This equipment complies with radiation exposure limits set forth for an uncontrolled environment. End users must follow the specific operating instructions for satisfying RF exposure compliance. This transmitter must be at least 20 cm from the user and must not be collocated or operated in conjunction with any other antenna or transmitter.

Notice for Industry Canada

This Class A digital apparatus complies with Canadian ICES-003.

Cet appareil numérique de la classe A est conforme à la norme NMB-003 du Canada.

Radio Notice for Industry Canada

Caution

This IC RSS-210 radio device operates on a non-interference basis with other devices operating at this frequency. Any changes or modification to said product not expressly approved by Monoprice, including the use of non-approved antennas, could void the user's authority to operate this device.

This device complies with IC RSS-210. Operation is subject to the following two conditions: (1) this device may not cause harmful interference, and (2) this device must accept any interference received, including interference that may cause undesired operation.

RF Exposure Statement for Industry Canada

Caution

This equipment complies with radiation exposure limits set forth for an uncontrolled environment. End users must follow the specific operating instructions for satisfying RF exposure compliance. This transmitter must be at least 20 cm from the user and must not be collocated or operated in conjunction with any other antenna or transmitter.

Android™ and Google Play™ are trademarks of Google LLC.

Cisco® and IOS® are registered trademarks or trademarks of Cisco Systems, Inc. and/or its affiliates in the United States and certain other countries.

Wi-Fi® is a registered trademark of Wi-Fi Alliance.