



## SB-200SW Premium Slim Soundbar with Wireless Subwoofer



P/N 38037

**User's Manual**

# CONTENTS

SAFETY WARNINGS AND GUIDELINES .....	4
FEATURES.....	5
CUSTOMER SERVICE.....	6
PACKAGE CONTENTS .....	6
PRODUCT OVERVIEW .....	7
Soundbar Front Panel.....	7
Soundbar Top Panel .....	7
Soundbar Rear Panel.....	8
Remote Control.....	9
Subwoofer Rear Panel.....	10
IR REMOTE CONTROL .....	10
Preparation For Use.....	10
Replacing the Battery .....	11
CONNECTIONS.....	11
HDMI ARC.....	11
OPTICAL.....	12
COAXIAL .....	12
AUX.....	12
Power .....	13
PAIRING THE SOUNDBAR AND SUBWOOFER.....	13
Automatic Pairing.....	13
Manual Pairing.....	13
OPERATION.....	14
Power .....	14

Bluetooth Pairing.....	15
Disconnecting Bluetooth.....	16
TROUBLESHOOTING .....	16
SPECIFICATIONS.....	17
TECHNICAL SUPPORT.....	18
REGULATORY COMPLIANCE.....	18
Notice for FCC.....	18
Radio Notice for FCC.....	19
Notice for Industry Canada.....	19
Radio Notice for Industry Canada.....	20

## SAFETY WARNINGS AND GUIDELINES

Please read this entire manual before using this device, paying extra attention to these safety warnings and guidelines. Please keep this manual in a safe place for future reference.

- This device is intended for indoor use only.
- Do not expose this device to water or moisture of any kind. Do not place drinks or other containers with moisture on or near the device. If moisture does get in or on the device, immediately unplug it from the power outlet and allow it to fully dry before reapplying power.
- Do not touch the device, the power cord, or any other connected cables with wet hands.
- If operating this speaker in a humid environment, ensure that no condensation occurs. Condensation could cause damage to the speaker cone and could cause a short in the amplifier, which in turn could cause fire or severe electric shock.
- Do not install this device on an unstable surface where it could fall and cause either personal injury or damage to the device and/or other equipment.
- Do not expose this device to excessive vibration.
- Do not expose this device to excessively high temperatures. Do not place it in, on, or near a heat source, such as a fireplace, stove, radiator, etc. Do not leave it in direct sunlight.
- Do not place or install this device in an area where it can be exposed to excessive amounts of dust, humidity, oil, smoke, or combustible vapors.
- Prior to operation, check the unit and power cord for physical damage. Do not use if physical damage has occurred.
- Before plugging the unit into a power outlet, ensure that the outlet provides the same type and level of power required by the device.
- Unplug this device from the power source when not in use.
- Take care to prevent damage to the power cord. Do not allow it to become crimped, pinched, walked on, or become tangled with other cords. Ensure that the power cord does not present a tripping hazard.

- Never unplug the unit by pulling on the power cord. Always grasp the connector head or adapter body.
- Ensure that power is turned off and disconnected before making any electrical connections.
- Remove the battery from the controller if it will go unused for a lengthy period of time.
- Clean using a soft, dry cloth only. Do not use chemical cleaners, solvents, or detergents. For stubborn deposits, moisten the cloth with warm water.
- This device has no user serviceable parts. Do not attempt to open, service, or modify this device.

## FEATURES

- Includes a wireless Bluetooth® connection
- Features HDMI® Audio Return Channel, digital coaxial, digital optical, and 3.5mm AUX inputs
- Includes an IR remote control
- Includes a wireless subwoofer
- 60 watts (RMS) power output for the soundbar
- 60 watts (RMS) power output for the subwoofer
- 40Hz ~ 20kHz overall frequency response
- Nominal 8 ohm impedance

## CUSTOMER SERVICE

The Monoprice Customer Service department is dedicated to ensuring that your ordering, purchasing, and delivery experience is second to none. If you have any problem with your order, please give us an opportunity to make it right. You can contact a Monoprice Customer Service representative through the Live Chat link on our website [www.monoprice.com](http://www.monoprice.com) or via email at [support@monoprice.com](mailto:support@monoprice.com). Check the website for support times and links.

## PACKAGE CONTENTS

Please take an inventory of the package contents to ensure you have all the items listed below. If anything is missing or damaged, please contact Monoprice Customer Service for a replacement.

1x Soundbar

1x Wireless subwoofer

1x IR remote control

2x AC power cords

1x 3.5mm to 3.5mm audio cable

1x 3.5mm to RCA audio

1x User's manual

1x Thank you card

# PRODUCT OVERVIEW

## Soundbar Front Panel

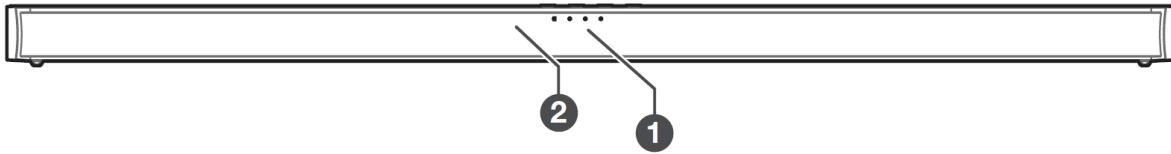

1. **LED Indicators:** The LEDs indicate the mode and operation status. The different colors and their meaning are as follows:
  - **Solid Red:** The soundbar is in Standby Mode.
  - **Solid Green:** The soundbar is powered on and in AUX Mode.
  - **Solid Blue:** The soundbar is powered on and in Bluetooth® Mode.
  - **Flashing Blue:** The soundbar is powered on and in Bluetooth Pairing Mode.
  - **Solid Orange:** The soundbar is powered on and in Optical Mode.
  - **Flashing Orange:** The soundbar is powered on and in Coaxial Mode.
  - **Solid White:** The soundbar is powered on and in HDMI® ARC (audio return channel) Mode.
2. **IR Receiver:** Aim the included remote control at the **IR Receiver** on the front panel.

## Soundbar Top Panel

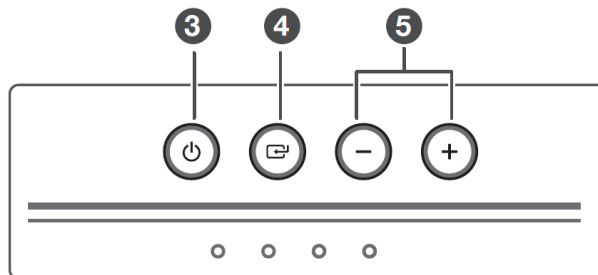

3. **Power:** Press the **Power** button to turn the soundbar on or to put it in Standby Mode.

4. **Source:** Press the **Source** button to cycle through the various inputs. The order of the inputs is AUX, Bluetooth®, Optical, Coaxial, and HDMI® ARC.
5. **Volume:** Press the - button to decrease the volume level or the + button to increase the volume level.

## Soundbar Rear Panel

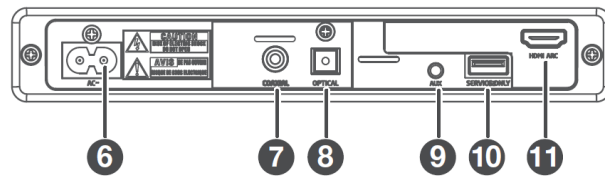

6. **AC:** AC socket for connecting the included AC power cord.
7. **COAXIAL:** Digital coaxial audio input.
8. **OPTICAL:** Digital optical audio input.
9. **AUX:** 3.5mm stereo analog AUX audio input.
10. **SERVICE ONLY:** USB port for servicing the soundbar at the factory. This is NOT an audio input and should not be used.
11. **HDMI ARC:** HDMI® port for connecting your television for audio using the Audio Return Channel (ARC) feature, which allows the soundbar to play audio from your television.



## Remote Control

1. **POWER:** Press the **Power** button to turn the soundbar on or to put it in Standby Mode.
2. **SOURCE:** Press one of the **Source** buttons to select the indicated source.
3. **VOL+/VOL-:** Press the **VOL+** button to increase the volume level or **VOL-** to decrease the volume level.
4. **EQ:** Press one of the **EQ** buttons to select a different EQ setting.
5. **MUTE:** Press the button to turn audio muting on or off.
6. **▶||/▶||:** Press the **▶||** button to skip forward to the next track in Bluetooth® Mode or press the **||◀** button to skip back to the previous track in Bluetooth Mode.
7. **▶||/PAIR:** Momentarily press the **▶||/PAIR** button in Bluetooth® Mode to pause or resume playback. Press and hold the **▶||/PAIR** button put the soundbar in Bluetooth Pairing Mode when no Bluetooth pairing exists. If a device is already paired with the soundbar, press and hold the **▶||/PAIR** to delete the existing Bluetooth pairing.

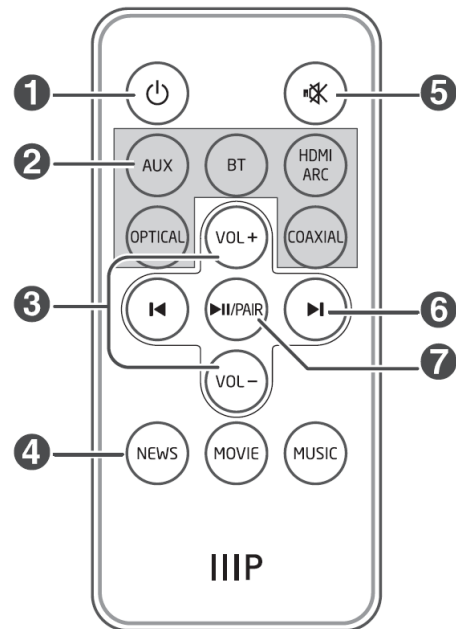

## Subwoofer Rear Panel

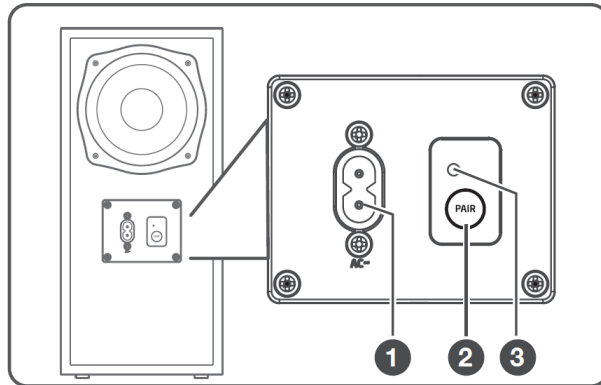

1. **AC:** AC socket for connecting the included AC power cord.
2. **PAIR:** Press the **PAIR** button to manually pair the subwoofer with the soundbar.
3. **PAIRED LED:** The LED illuminates, flashes rapidly while pairing with the soundbar. It flashes slowly when the wireless pairing has failed. It illuminates solid when the subwoofer is paired with the soundbar.

## IR REMOTE CONTROL

### Preparation For Use

The included IR remote control features an installed CR2025 battery. To prevent the battery from discharging during shipping, a plastic tab is installed. Prior to use, pull the tab to remove it, as indicated in the image to the right.

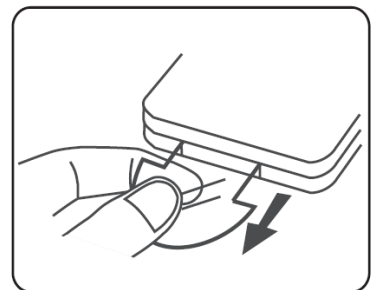

## Replacing the Battery

With continued use, the battery will eventually need to be replaced. Perform the following steps to replace the CR2025 battery.

1. Invert the remote, then push the tab on the edge of the tray towards the tray.
2. Pull the tray out of the remote.
3. Remove the old battery, then insert the new battery into the tray with the + terminal facing up.
4. Insert the tray into the remote until it clicks into place.

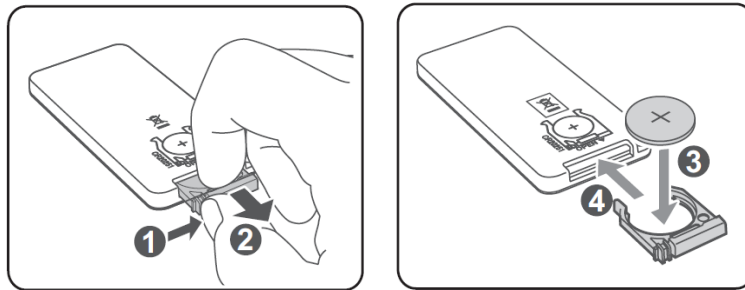

## CONNECTIONS

### HDMI ARC

The soundbar includes an HDMI® ARC (Audio Return Channel) input, which allows you to send audio from your TV to the soundbar over a single HDMI cable. Note that your TV must support both the HDMI ARC and HDMI CEC (Consumer Electronics Control) features and be setup accordingly.

Using a High Speed HDMI Cable (not included), plug one end into the **HDMI ARC** port on the soundbar, then plug the other end into the HDMI ARC output on your TV. Note that the cable must be compliant with the HDMI 1.4 specification or later.

When properly configured, your TV remote control can be used to change the soundbar's volume.

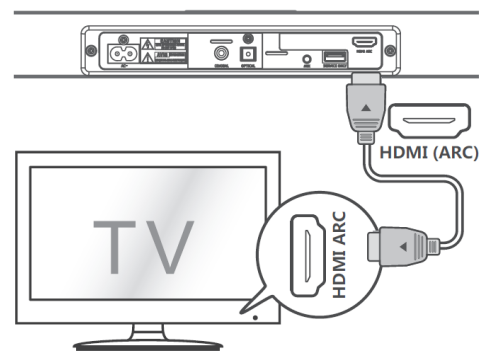

## OPTICAL

The soundbar features a digital optical audio input, allowing you to connect your TV or other audio source. Perform the following steps to use the **OPTICAL** input.

1. Remove the small, protective plug from the **OPTICAL** input on the soundbar.
2. Using a digital optical audio cable (not included), plug one end into the **OPTICAL** input on the soundbar, then plug the other end into the OPTICAL output of your TV or other audio source.

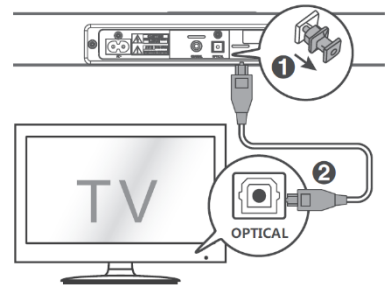

## COAXIAL

The soundbar features a digital coaxial audio input, allowing you to connect your TV or other audio source.

Using a digital coaxial audio cable (not included), plug one end into the **COAXIAL** input on the soundbar, then plug the other end into the COAXIAL output of your TV or other audio source.

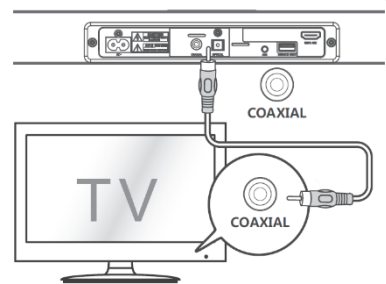

## AUX

The soundbar features a 3.5mm AUX jack, allowing you to connect your TV, smartphone, or other audio source. Perform one of the following steps to use the **AUX** input.

- A: Using the included 3.5mm to 3.5mm audio cable, plug one end into the **AUX** input on the soundbar, then plug the other end into the headphone output on your smartphone, TV, or other audio source.
- B: Using the included 3.5mm to RCA audio cable, plug the 3.5mm end into the **AUX** input on the soundbar, then plug the other end into the RCA audio outputs on your TV or other audio source.

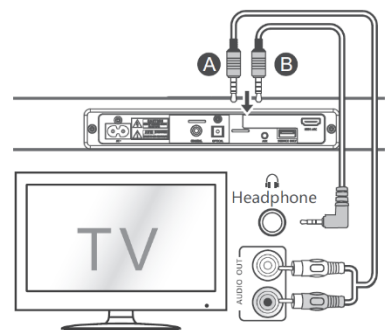

## Power

Perform the following steps to connect the soundbar and subwoofer to AC power.

1. Plug one of one of the included AC power cords into the **AC** socket on the soundbar, then plug the other end into a nearby AC power outlet.
2. Plug one of one of the included AC power cords into the **AC** socket on the subwoofer, then plug the other end into a nearby AC power outlet.

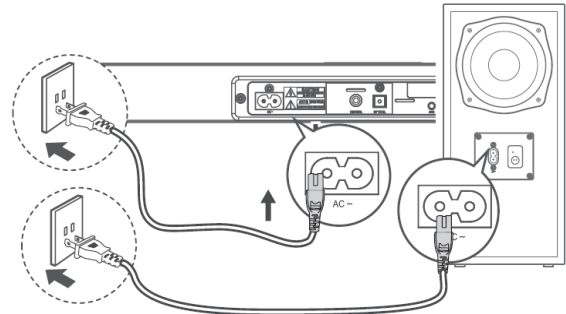

## PAIRING THE SOUNDBAR AND SUBWOOFER

### Automatic Pairing

The subwoofer and soundbar will automatically pair when both units are plugged in and powered on.

#### Notes:

- Do not press the **PAIR** button on the subwoofer, unless performing manual pairing.
- If automatic pairing fails, perform manual pairing.

### Manual Pairing

Perform the following steps to manually pair the subwoofer and soundbar.

1. Ensure that the soundbar is in Standby Mode.
2. Press and hold the **PAIR** button on the rear of the subwoofer for a few seconds. The subwoofer will enter Pairing Mode and the **Paired LED** will begin blinking rapidly.
3. Press the **Power** button on the soundbar top panel or the remote control to turn the soundbar on.

4. After the connection is established, the **Paired LED** will cease blinking and illuminate solid.
5. If the **Paired LED** starts blinking slowly, the wireless connection has failed. Unplug the subwoofer, wait for 3 minutes, then plug it back in and repeat steps 1-4.

#### Notes:

- If the wireless connection fails again, check to see if there is a conflict or strong interference from other electronic devices. Remove the conflicts or source of interference, then repeat the pairing procedure.
- The subwoofer should be located in an open area within 19 feet (6 meters) of the soundbar.
- If the soundbar is powered on and is not connected with the subwoofer, the **POWER** indicator on the soundbar will flash. Repeat the above steps to establish a wireless connection.

## OPERATION

### Power

- When you first plug the soundbar into an AC power outlet, it is in Standby Mode.
- Press the **Power** button on the soundbar top panel or IR remote control to power the soundbar on.
- Press the **Power** button again to put the soundbar back into Standby Mode.
- If using the HDMI® ARC input, turning your TV on will turn the soundbar on at the same time.
- After about 15 minutes with no input, the soundbar will automatically switch to Standby Mode.
- Unplug the soundbar from the AC power outlet to turn the soundbar completely off.

## Bluetooth Pairing

To use the Bluetooth® audio connection, you must first pair the soundbar with your mobile device. Perform the following steps to pair the soundbar with your mobile device.

1. Ensure that your mobile device is located within about 26 feet (8 meters) of the soundbar. For best results, ensure they are within 3 feet (1 meter).
2. Press the **Power** button on the soundbar top panel or on the IR remote control to turn the soundbar on.
3. Press the **Source** button on the soundbar top panel repeatedly until the **LED Indicator** begins flashing blue, indicating the soundbar is in Bluetooth pairing mode. Alternatively, press the **BT** button on the remote control. The soundbar will say **Pairing**.
4. Open the Bluetooth settings on your mobile device and scan for nearby Bluetooth devices.
5. Locate and select the **SB200SW** entry. If prompted for a passcode, enter **0000** (four zeros). If you cannot locate the **SB200SW** entry, press and hold the **▶ I/PAIR** button on the remote control until you hear the **Pairing** voice prompt.
6. Once the soundbar is paired with your mobile device, the soundbar will say **Paired** and the **LED Indicator** will stop flashing blue and will illuminate solid blue.

### Notes:

- To play audio from your mobile device, it must support the Advanced Audio Distribution Profile (A2DP).
- If your mobile device supports the Audio Video Remote Control Profile (AVRCP), you can use the soundbar's remote control to control audio playback.
- The soundbar has an unobstructed Bluetooth range of about 26 feet (8 meters). Any obstacles between the soundbar and your mobile device will reduce that range.
- If you lose connection, the soundbar will automatically re-enter Bluetooth pairing mode.
- If no device is paired with the soundbar within 2 minutes, the soundbar will restore any previous Bluetooth pairing.

## Disconnecting Bluetooth

You can break the Bluetooth connection between the soundbar and your mobile device using one of the following methods.

- Press the **Source** button on the soundbar top panel or press one of the **Source** buttons on the remote control other than the **BT** button to change the soundbar to a different mode.
- Disable Bluetooth on your mobile device. The soundbar will say **Disconnected**.
- Press and hold the ► **I/PAIR** button on the remote control.

## TROUBLESHOOTING

Q1: There is no power.

A1: Ensure that the AC power cord is properly connected and plugged into an AC power outlet. Ensure that the outlet is live by plugging in a different device, such as a lamp. Press the **Power** button to turn the soundbar on. Try unplugging the soundbar, wait 30 seconds, then plug it back in again.

Q2: There is no sound.

A2: Increase the volume. Press the **MUTE** button on the remote control to ensure muting is not on. Try playing audio from a different source. If using digital audio, ensure that your TV or other audio source device is configured to output PCM audio. Try connecting directly to your audio source device in case the TV does not pass through the audio. Ensure that your TV's audio output is set to **FIXED** or **STANDARD** and is not set to **VARIABLE**. If using a Bluetooth® connection, ensure that the volume on your mobile device is turned up and that it is not muted.



Q3: The remote control doesn't work.

A3: Ensure you have the correct source selected. Ensure you are aiming the remote control at the **IR Receiver** on the soundbar's front panel. Check the remote's battery to ensure polarity is properly aligned. Try replacing the battery.

## SPECIFICATIONS

Model	38037
Audio Inputs	HDMI® ARC, Bluetooth®, digital optical, digital coaxial, 3.5mm stereo analog
Bluetooth Version	4.2
Bluetooth Pairing Name	SB200SW
Bluetooth Range	26 feet (8 meters)
Audio Input Sensitivity	500mV
Subwoofer and Soundbar Output Power	60 watts (RMS) each
Soundbar Frequency Response	120Hz ~ 20kHz
Subwoofer Frequency Response	40 ~ 120 Hz
Nominal Impedance	8 ohms
Wireless Frequency	2400 ~ 2483 MHz
Remote Control Battery Type	1x CR2025
Input Voltage	100 ~ 240 VAC, 50/60 Hz
Soundbar Power Consumption	30 watts
Subwoofer Power Consumption	30 watts
Soundbar Dimensions	35.4" x 3.4" x 1.8" (900 x 86 x 45 mm)
Subwoofer Dimensions	5.9" x 8.7" x 12.6" (150 x 220 x 320 mm)

## TECHNICAL SUPPORT

Monoprice is pleased to provide free, live, online technical support to assist you with any questions you may have about installation, setup, troubleshooting, or product recommendations. If you ever need assistance with your new product, please come online to talk to one of our friendly and knowledgeable Tech Support Associates. Technical support is available through the online chat button on our website [www.monoprice.com](http://www.monoprice.com) or through email by sending a message to [tech@monoprice.com](mailto:tech@monoprice.com). Check the website for support times and links.

## REGULATORY COMPLIANCE

### Notice for FCC



This device complies with Part 15 of the FCC rules. Operation is subject to the following two conditions: (1) this device may not cause harmful interference, and (2) this device must accept any interference received, including interference that may cause undesired operation.

Modifying the equipment without Monoprice's authorization may result in the equipment no longer complying with FCC requirements for Class B digital devices. In that event, your right to use the equipment may be limited by FCC regulations, and you may be required to correct any interference to radio or television communications at your own expense.

This equipment has been tested and found to comply with the limits for a Class B digital device, pursuant to Part 15 of the FCC Rules. These limits are designed to provide reasonable protection against harmful interference in a residential installation. This equipment generates, uses and can radiate radio frequency energy and, if not installed and used in accordance with the instructions, may cause harmful interference to radio communications. However, there is no guarantee that interference will not occur in a particular installation. If this equipment does cause harmful interference to radio or television reception, which can be determined by turning the equipment off and on, the

user is encouraged to try to correct the interference by one or more of the following measures:

- Reorient or relocate the receiving antenna.
- Increase the separation between the equipment and receiver.
- Connect the equipment into an outlet on a circuit different from that to which the receiver is connected.
- Consult the dealer or an experienced radio/TV technician for help.

## Radio Notice for FCC



### Caution

This FCC Part 15 radio device operates on a non-interference basis with other devices operating at this frequency. Any changes or modification to said product not expressly approved by Monoprice, including the use of non-approved antennas, could void the user's authority to operate this device.

This device complies with Part 15 of the FCC Rules. Operation is subject to the following two conditions: (1) this device may not cause harmful interference, and (2) this device must accept any interference received, including interference that may cause undesired operation.

## Notice for Industry Canada

This Class B digital apparatus complies with Canadian ICES-003.

Cet appareil numérique de la classe B est conforme à la norme NMB-003 du Canada.

## Radio Notice for Industry Canada

### Caution

This IC RSS-210 radio device operates on a non-interference basis with other devices operating at this frequency. Any changes or modification to said product not expressly approved by Monoprice, including the use of non-approved antennas, could void the user's authority to operate this device.

This device complies with IC RSS-210. Operation is subject to the following two conditions: (1) this device may not cause harmful interference, and (2) this device must accept any interference received, including interference that may cause undesired operation.

*The Bluetooth® word mark and logos are registered trademarks of Bluetooth SIG, Inc. HDMI®, the HDMI Logo, and High-Definition Multimedia Interface are trademarks or registered trademarks of HDMI Licensing LLC in the United States and other countries.*