

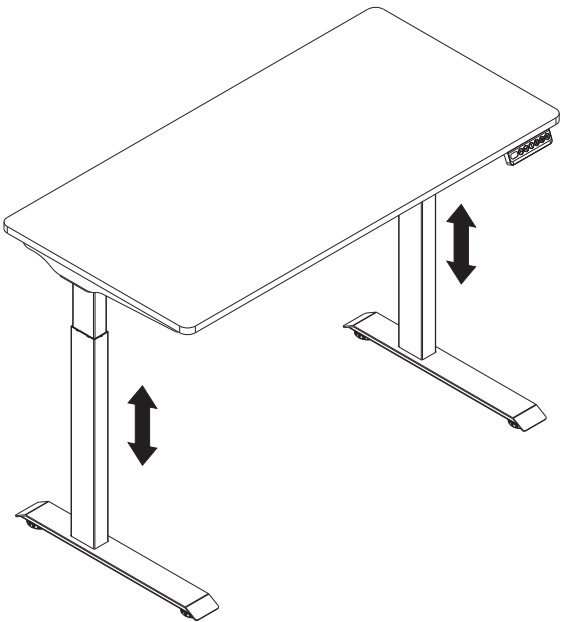

Single Motor Sit-Stand Desk with Top

INSTALLATION GUIDE P/N 42763/42764



SPECIFICATIONS

Leg Columns	2
Maximim Load	110 lbs. (50kg)
Maximum Speed	1 in. (25mm)/sec.
Input Voltage	100-240V
Minimum Height	28.8 in. (730mm)
Maximum Height	48.4 in. (1230mm)
Desktop Dimensions	23.6 x 47.2 in. (1200 x 600mm)
Duty Cycle	2 min. continuous operation (@18 min. intervals)
Operating Temperature	32~104°F (0~40°C)

PACKAGE CONTENTS

A x3

B x4

C x8

D x1

No.	Part	Qty	No.	Part	Qty	No.	Part	Qty
①	Tabletop	1	②	Lifting column	2	③	Hand switch	1
④	Feet	2	⑤	Power plug	1	⑥	Adaptor	1
⑦	Cable mounts	4	⑧	Cable	1			

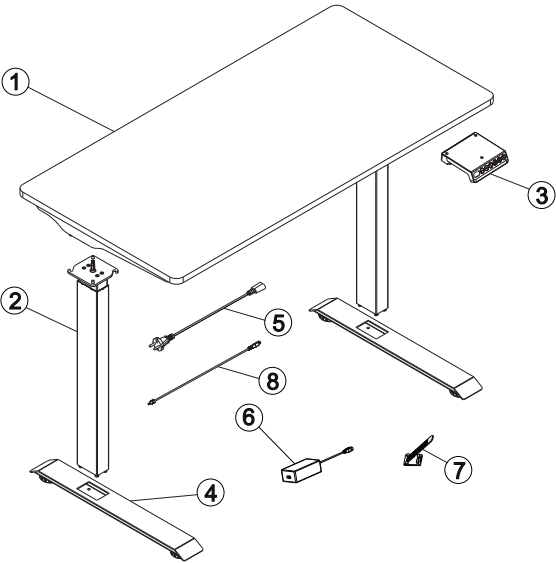

STEP1

Install the lifting column

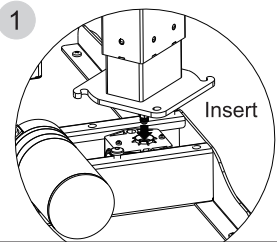
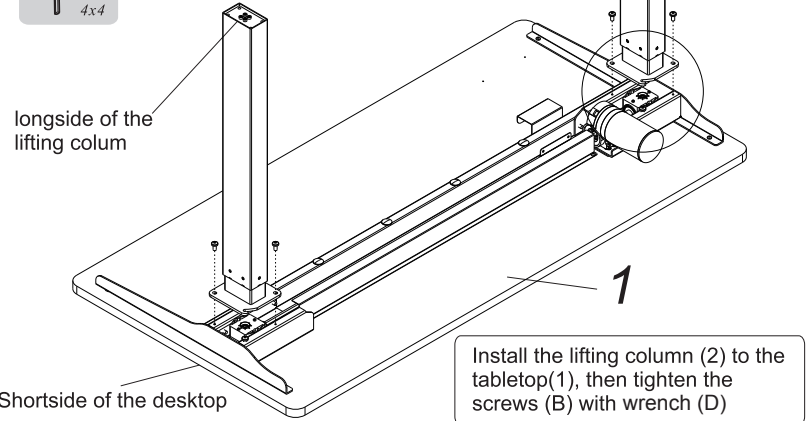

Insert the hexagon head of the column along the wiring trough, the side of the wire head facing the motor

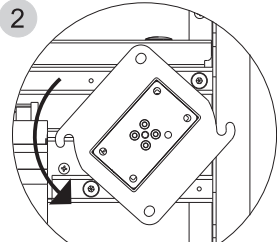

Rotate the column after inserting it, making the screws on the supporting beam into the column slot

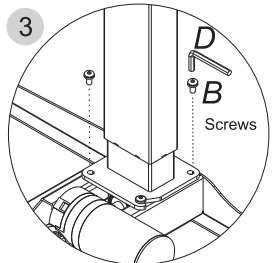

Tighten the screws(B) with 4x4 wrench

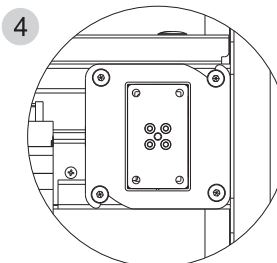

STEP2

Install the feet

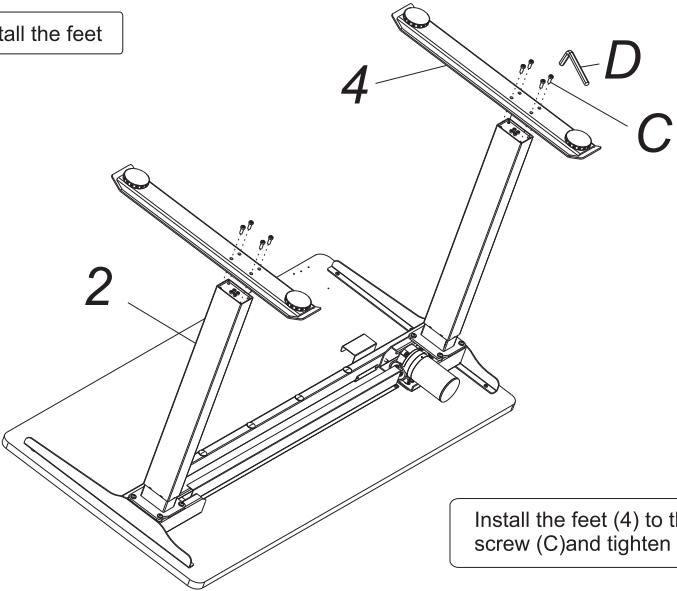
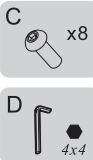

Install the feet (4) to the lifting columns (2) with the screw (C) and tighten it with 4*4 wrench (D)

STEP3

Install the hand switch

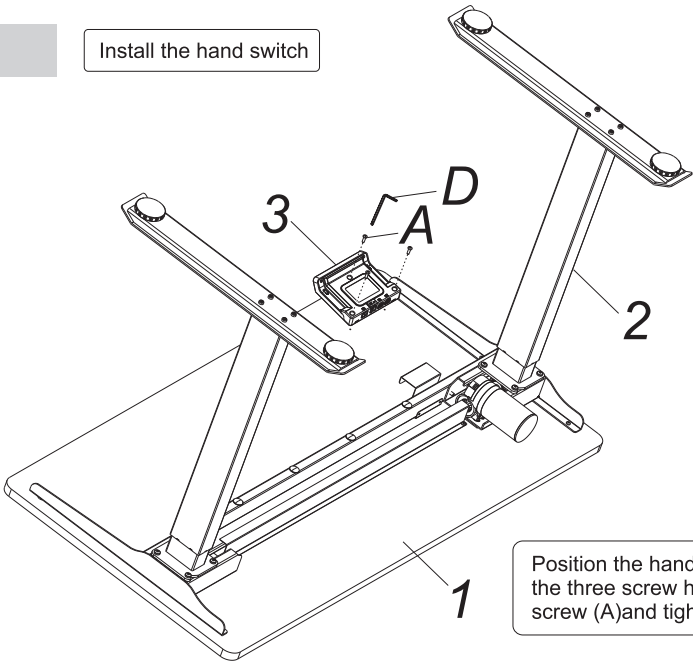
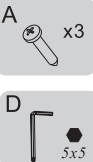

Position the hand switch (3) as shown in the picture to align the three screw holes on the tabletop, then fix it with the screw (A) and tighten it with 5*5 wrench (D)

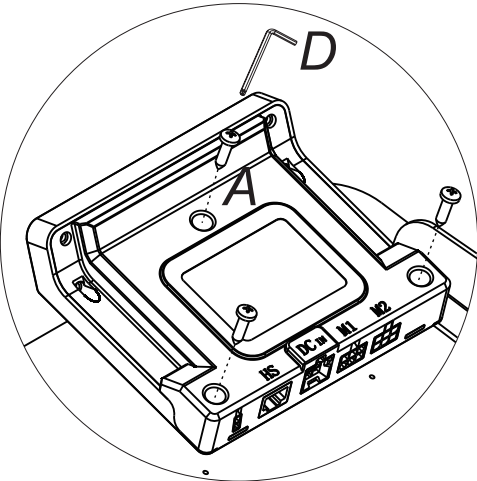

STEP4

Connect all cables to the adaptor

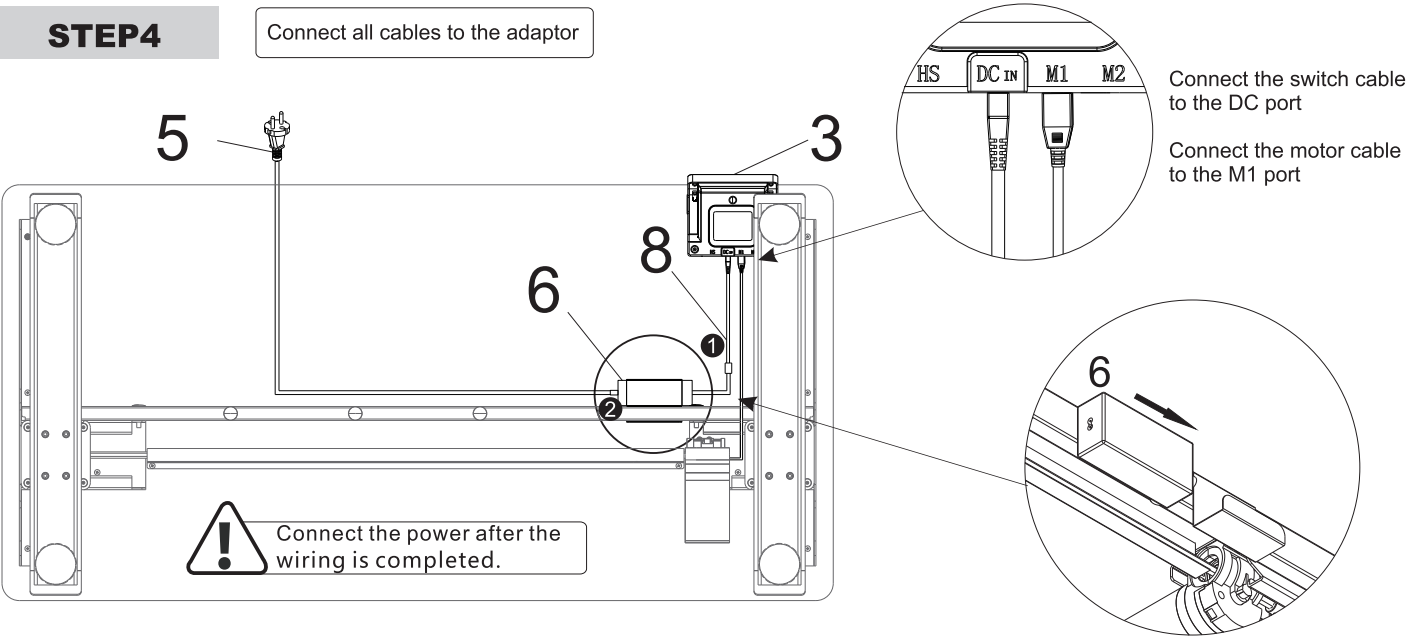

Connect the power after the wiring is completed.

Insert the adaptor(6) to the bracket of the tabletop

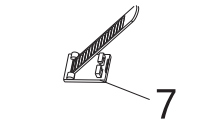
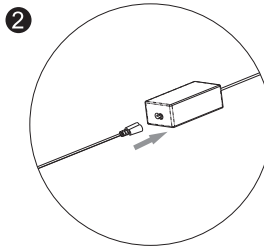
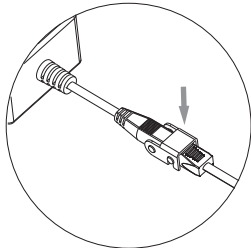
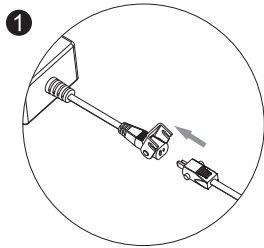

Fix the cables to the tabletop with cable management(7) to keep desk clean

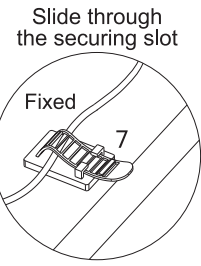
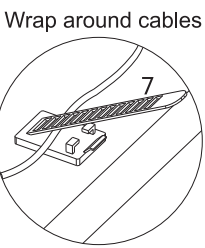
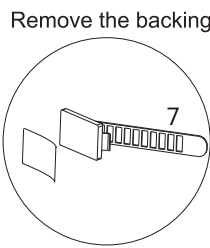

Troubleshooting

The following tips will help you detect and eliminate common faults and errors.
If the fault is not listed below, please contact customer support.

FAULT	SUGGESTED SOLUTION
No response while pressing the v arrow while properly connected to the power supply.	Ensure all cables are connected properly to both the power supply and the motor assembly.
No response while pressing the ^ arrow while properly connected to the power supply.	Ensure all cables are connected properly to both the power supply and the motor assembly.
The desk is lifting at a slower speed than usual or not lifting at all.	Ensure the desk is not attempting to lift more than the maximum weight listed in the specifications
The desk slowly lowers in height over time	Ensure the desk is not attempting to lift more than the maximum weight listed in the specifications
Overheated/Overloaded	Restart the desk after allowing it too cool down for 18 minutes.

! WARNING

- Only use the included Power Supply with this product. Specifications: AC 100-240V, 50/60Hz
- Only operate withing specified operating temperatures: 32-104°F (0-40°C)
- Unplug the desk from power before cleaning. Wipe dust from the surface using a damp cloth. Be careful not to allow moisture into internal assemblies or compartments.
- Properly dispose of electrical components, metals, plastics, wires etc. in accordance with environmental legislation, not along with general household waste.
- Ensure the desk is properly connected to power and correctly assembled before use.
- Thoroughly read the installation guide fro both the desk and control module before use.
- The desk is NOT A TOY. Improper use of the product may result in serious injury.
- Children, individuals with reduced physical, sensory, or metal capabilities should not be allowed to operate the desk without proper supervision.
- A slight vibration-like noise is to be expected during stopping and starting of the motor.
- Do not use corrosive or abrasive materials for cleaning the product.
- If any part of the product or cables become damaged, replace immediately with manufacturer approved parts or a replacement product. DO NOT use a damaged product.
- Keep the original product packaging for use when sending back for repairs or maintenance.

Waste disposal



This marking indicates that this product should not be disposed with other household wastes. To prevent possible harm to the environment or human health from uncontrolled waste disposal, recycle it responsibly to promote the sustainable reuse of material resources. To return your used device, please use the return and collection systems or contact the retailer where the product was purchased. They can take this product for environmental safe recycling.