

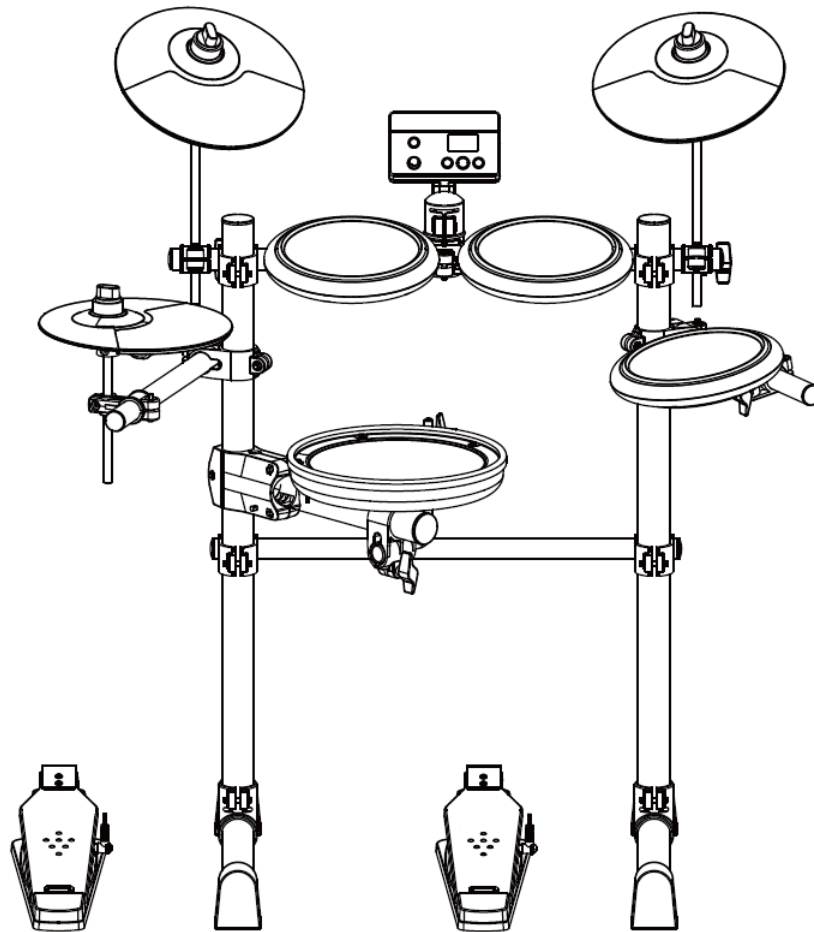

5-piece Electronic Drum Kit



P/N 625921

User's Manual

CONTENTS

SAFETY WARNINGS AND GUIDELINES	3
FEATURES.....	4
PACKAGE CONTENTS	4
CUSTOMER SERVICE	6
PRODUCT OVERVIEW	6
Host Machine.....	6
Assembled Kit.....	7
ASSEMBLY	8
SETUP	16
BASIC OPERATION.....	16
ADVANCED OPERATION.....	17
Pedal Adjust	17
Software Update.....	17
Factory Reset	18
System Version	18
BASIC PLAY	18
Hi-Hat and Hi-Hat Pedal	18
Bass Drum Pedal.....	18
Ride Cymbal.....	19
Snare Drum.....	19
MIDI FORMAT LIST	20
TECHNICAL SUPPORT	22
SPECIFICATIONS.....	22
REGULATORY COMPLIANCE.....	22

Notice for FCC.....	22
Notice for Industry Canada.....	23

SAFETY WARNINGS AND GUIDELINES

Please read this entire manual before using this device, paying extra attention to these safety warnings and guidelines. Please keep this manual in a safe place for future reference.

- This device is intended for indoor use only.
- Do not expose this device to water or moisture of any kind. Do not place drinks or other containers with moisture on or near the device. If moisture does get in or on the device, immediately remove it from its power source and allow it to fully dry before reapplying power.
- Do not touch the device, the power cord, or any other connected cables with wet hands.
- Unplug this device from the power source when not in use.
- Take care to prevent damage to the power cord. Do not allow it to become crimped, pinched, walked on, or become tangled with other cords. Ensure that the power cord does not present a tripping hazard.
- Never unplug the unit by pulling on the power cord. Always grasp the connector head or adapter body.
- Clean using a soft, dry cloth only. Do not use chemical cleaners, solvents, or detergents. For stubborn deposits, moisten the cloth with warm water.
- This device has no user serviceable parts. Do not attempt to open, service, or modify this device.

FEATURES

- Includes 12 preset drum sound kits
- Built-in metronome
- Headphone jack for low-volume play
- USB MIDI port for connecting a synthesizer or PC
- 10" plastic and silicone crash cymbal, ride cymbal, and hi-hat
- Three 6" toms and one 8" snare drum
- Toms and snare feature mesh heads for better feel and quieter play

PACKAGE CONTENTS

Please take an inventory of the package contents to ensure you have all the items listed below. If anything is missing or damaged, please contact Monoprice Customer Service for a replacement.

1x Drum Rack	1x Hi-Hat (HH) Cymbal
1x Hi-Hat (HH) Joint	1x Host Joint
1x Tom 1 and Tom 2 (T1 T2) Rail	1x Drum Sticks Holder
2x Rack Feet	1x Pair Drum Sticks
1x Hi-Hat (HH) Rod	1x Host Machine
2x Cymbal Rods	1x High Hat Pedal (HHP)
1x Tom 3 (T3) Pad	1x Bass Drum (BD) Pedal
1x Snare Drum (SD) Pad	1x Cable Assembly
1x Crash (CR) Cymbal	1x M6 Tool
1x Ride (RD) Cymbal	1x User's Manual

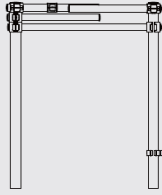

Drum Rack

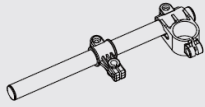

HH Joint



T1 T2 Rail

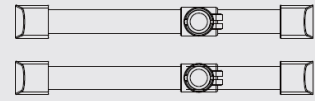

Rack Feet

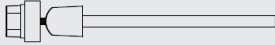

HH Rod

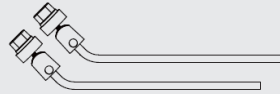

Cymbal Rods

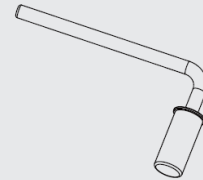

Cymbal Rods

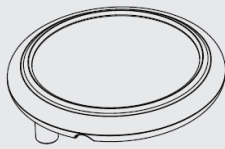

T3

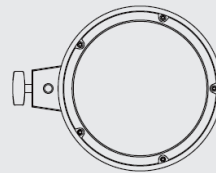

SD



CR

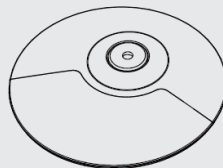

RD



HH

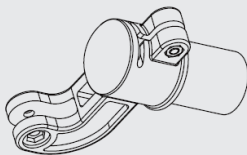

Host Joint

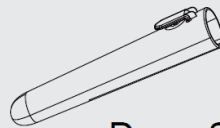

Drum Sticks Holder

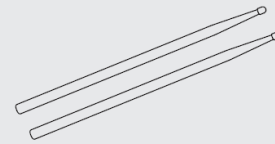

Drum Sticks

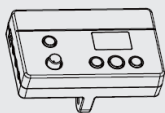

Host Machine



HHP



Bass Drum Pedal

CUSTOMER SERVICE

The Monoprice Customer Service department is dedicated to ensuring that your ordering, purchasing, and delivery experience is second to none. If you have any problem with your order, please give us an opportunity to make it right. You can contact a Monoprice Customer Service representative through the Live Chat link on our website www.monoprice.com or via email at support@monoprice.com. Check the website for support times and links.

PRODUCT OVERVIEW

Host Machine

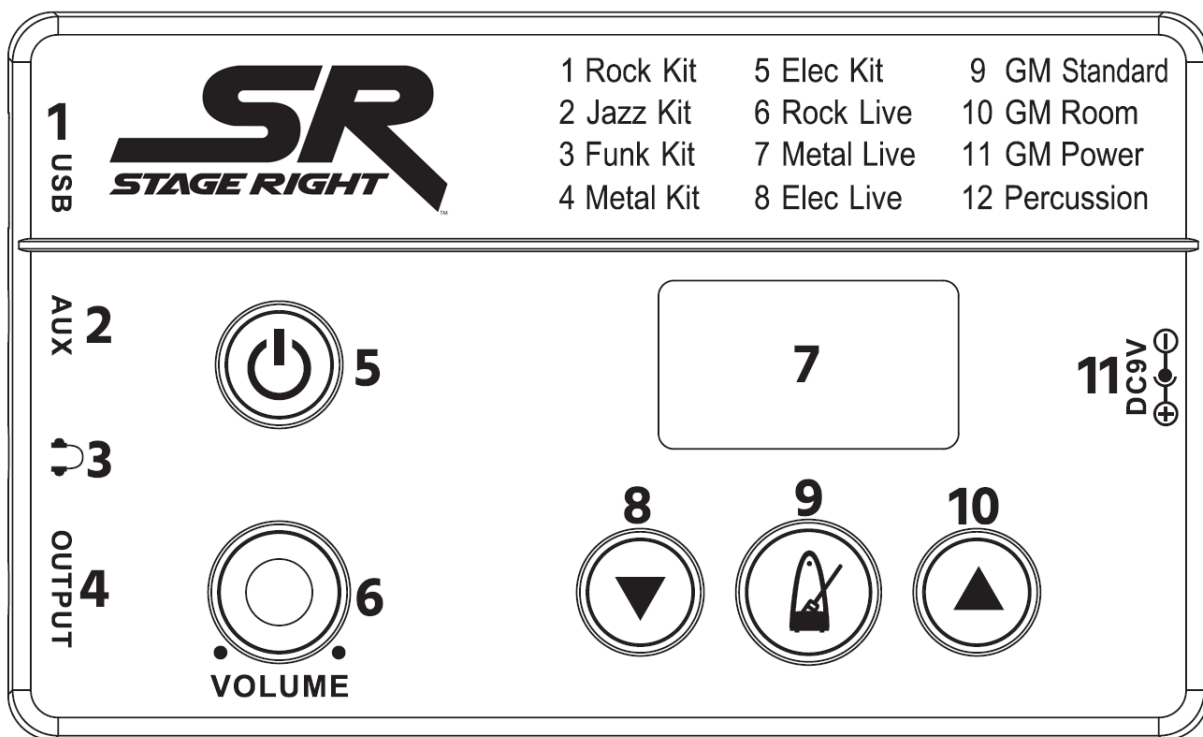

1. **USB:** USB MIDI port for connecting an external synthesizer or PC.
2. **AUX:** 3.5mm analog audio input.
3. **HEADPHONES:** 3.5mm stereo headphones output.
4. **OUTPUT:** 3.5mm analog audio output for connecting a drum amplifier.

5. **POWER:** Momentarily press the button to turn the Host Machine on. Press and hold the button for several seconds to turn the unit off.
6. **VOLUME:** Controls the output volume level.
7. **DISPLAY:** Displays the system status and menu selections.
8. **DOWN:** When the metronome is off, press the button to cycle down through the drum sound list. When the metronome is on, press the button to decrease the tempo and beat.
9. **METRONOME:** Press the button to turn the built-in metronome on or off.
10. **UP:** When the metronome is off, press the button to cycle up through the drum sound list. When the metronome is on, press the button to increase the tempo and beat.
11. **DC9V:** DC barrel connector for connecting the included AC power adapter.

Assembled Kit

1. **CR:** Crash Cymbal
2. **T1:** Tom 1
3. **HH:** Hi-Hat Cymbal
4. **SD:** Snare Drum
5. **HHP:** Hi-Hat Pedal
6. **RD:** Ride Cymbal
7. **T2:** Tom 2
8. **T3:** Tom 3
9. **BD:** Bass Drum Pedal

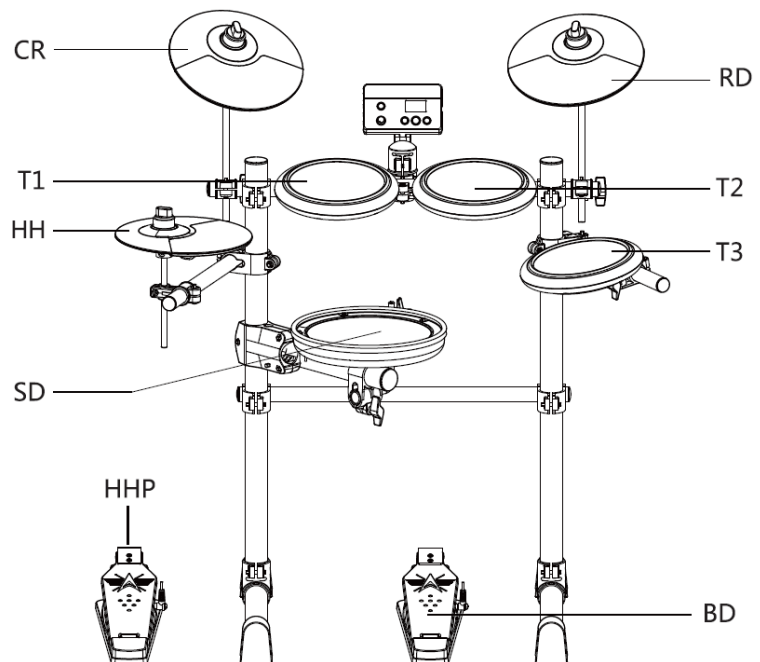

ASSEMBLY

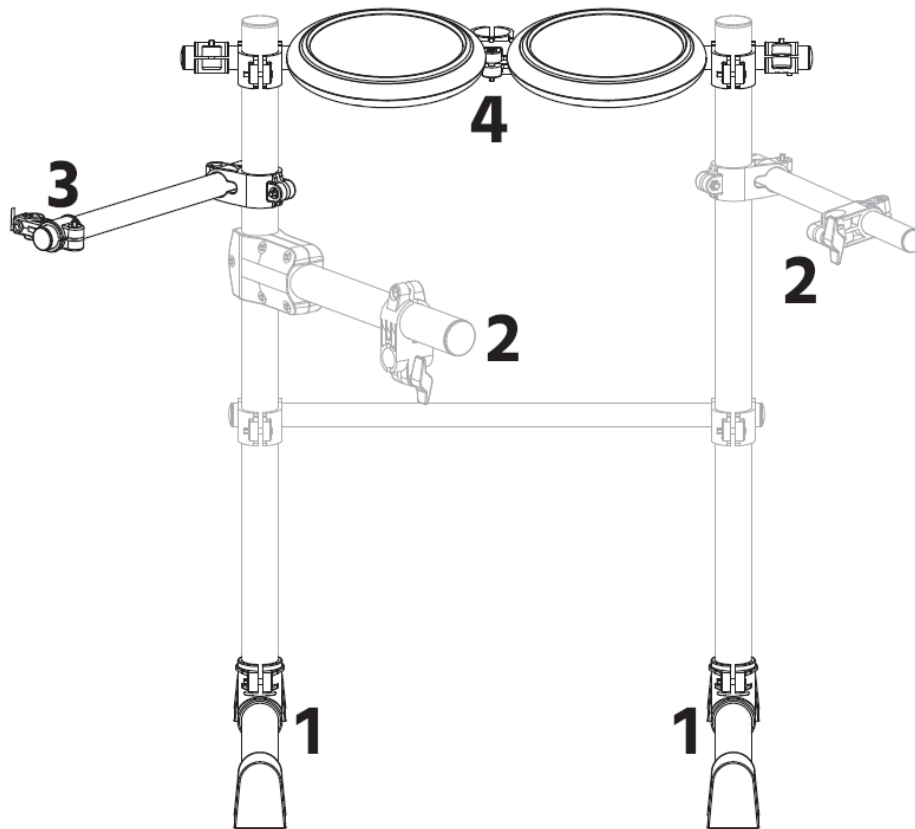

1. Place the two **Rack Feet** on one end of the **Drum Rack** assembly, then use the included M6 tool to tighten the clamps to secure them in place. Stand the assembly up on its feet.
2. Swing the **Snare Drum Joint** (left side arm of the **Drum Rack** assembly) and the **Tom 3 Joint** (right side arm of the **Drum Rack** assembly) out to the positions shown above, then use the included M6 tool to tighten the clamps to secure them in place.
3. Slide the **HH Joint** onto the left leg of the **Drum Rack** assembly to the position shown above, then use the included M6 tool to tighten the clamp to secure it in place.
4. Slide the **T1 T2 Rail** onto the two legs of the **Drum Rack** assembly, then use the included M6 tool to tighten the clamps to secure it in place.

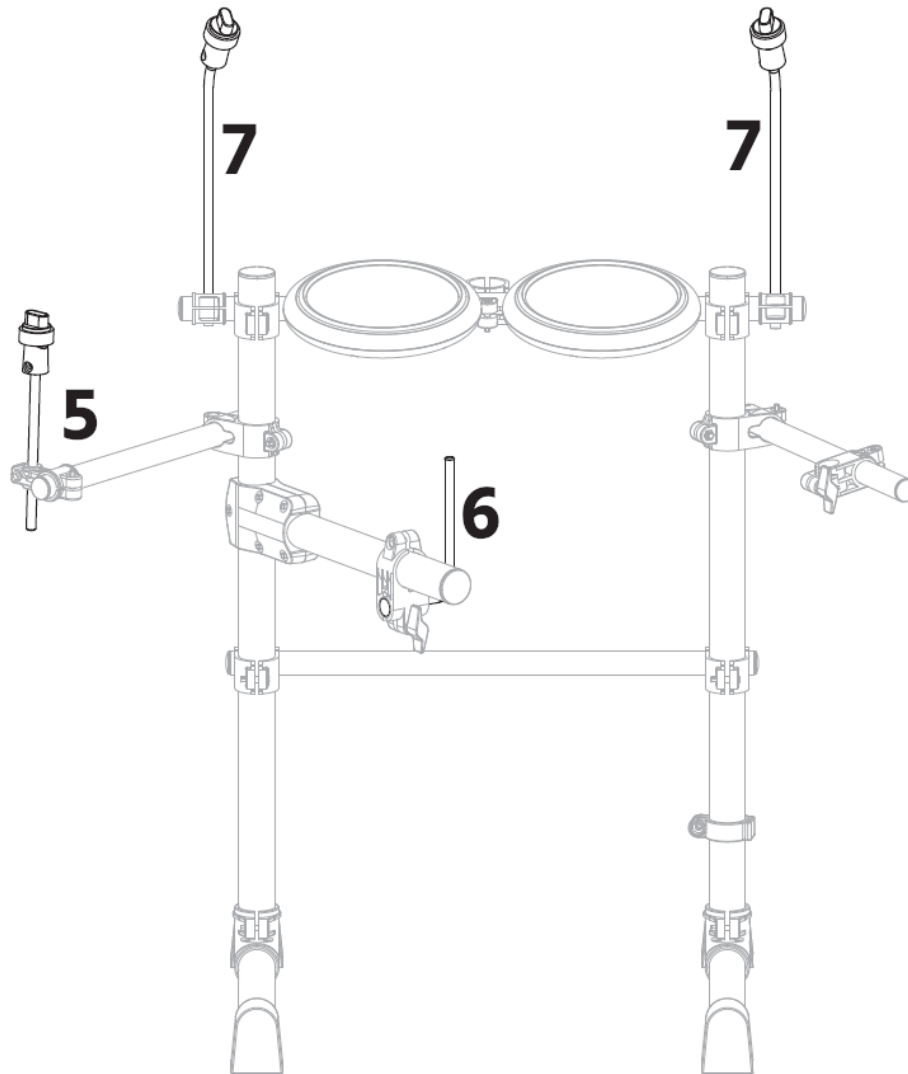

5. Insert the **HH Rod** into the clamp on the **HH Joint**, then use the included M6 tool to tighten the clamp to secure it in place.
6. Insert the single **Cymbal Rod** (with the 90° bend) into the clamp on the **Snare Drum Joint**, then use the included M6 tool to tighten the clamp to secure it in place.
7. Insert the two **Cymbal Rods** (with the 45° bend) into the clamps on each side of the **T1 T2 Rail**, then use the included M6 tool to tighten the clamps to secure them place.

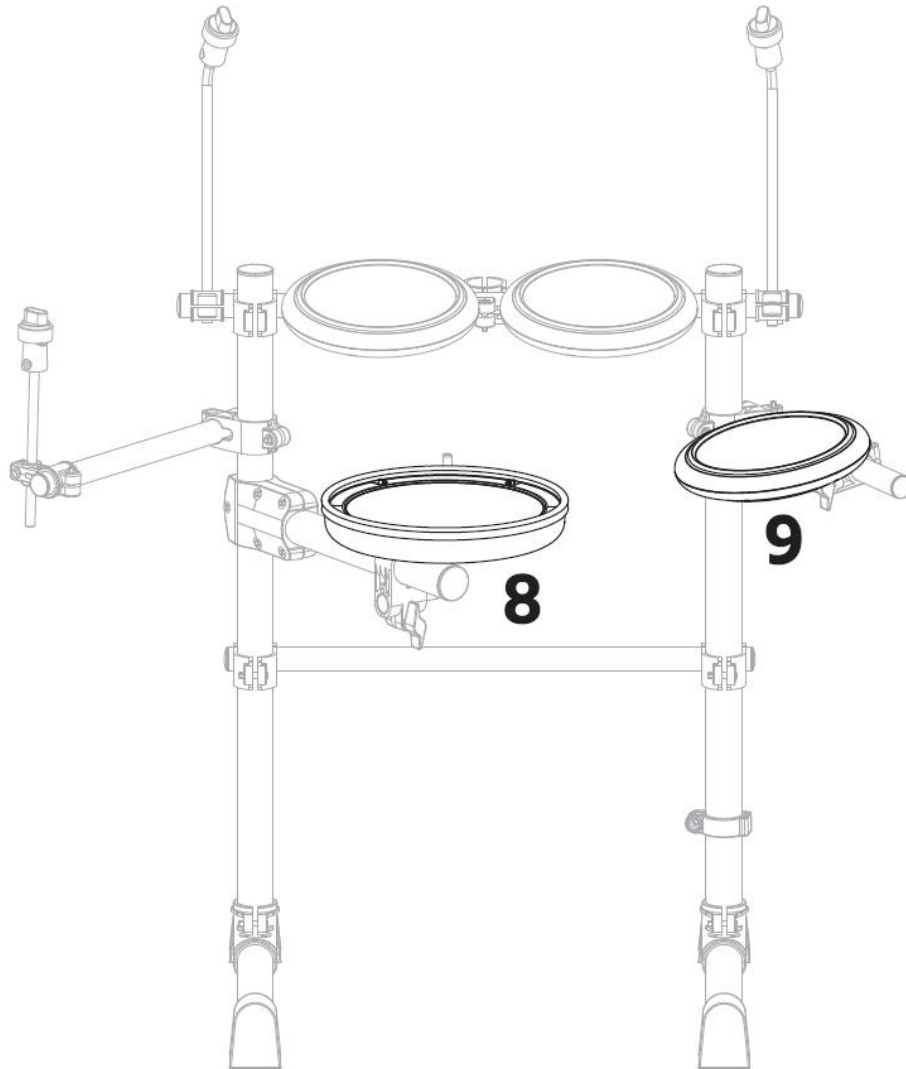

8. Attach the **Snare Drum Pad** to the **Cymbal Rod** on the **Snare Drum Joint** and secure it into place.
9. Attach the **Tom 3 Pad** to the **Tom 3 Joint** and secure it into place.

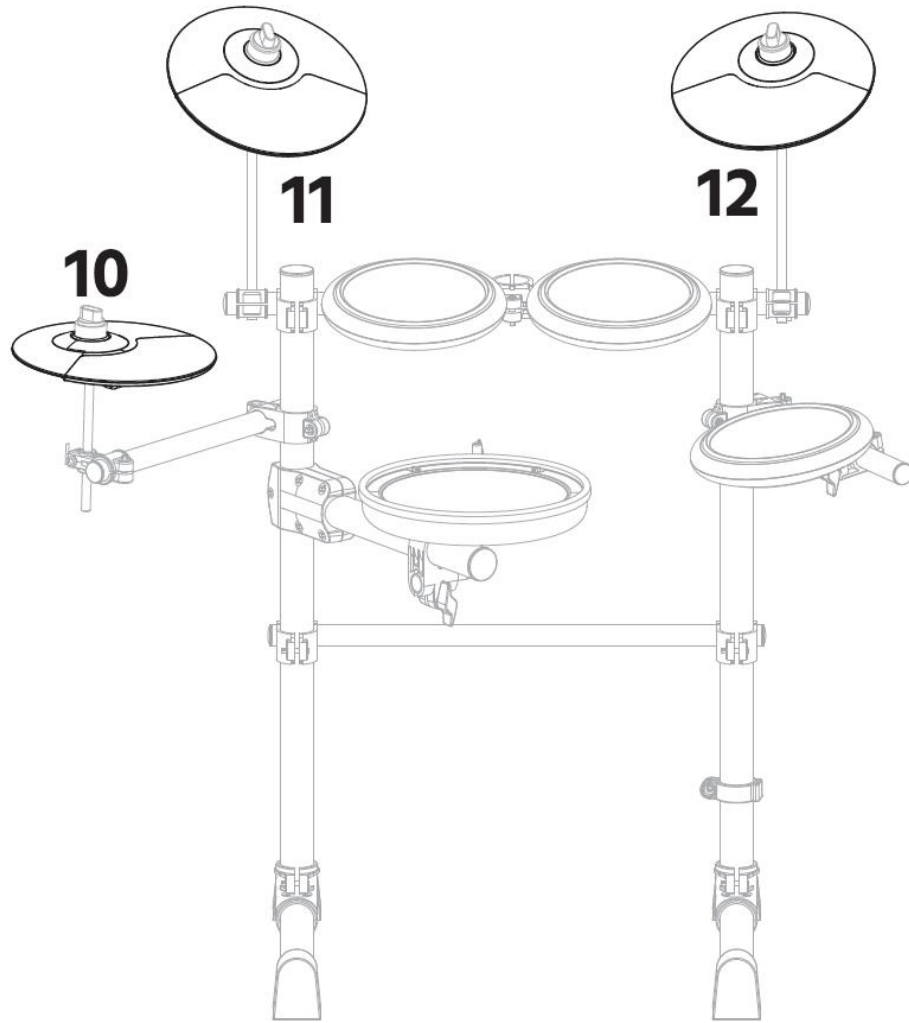

10. Unscrew the cap on the **Hi-Hat Rod**, place the **Hi-Hat Cymbal** onto the **Hi-Hat Rod**, then screw the cap back on to secure the **Hi-Hat Cymbal** in place.
11. Unscrew the cap on the **Cymbal Rod** on the left, place the **Crash Cymbal** onto the **Cymbal Rod**, then screw the cap back on to secure the **Crash Cymbal** in place.
12. Unscrew the cap on the **Cymbal Rod** on the right, place the **Ride Cymbal** onto the **Cymbal Rod**, then screw the cap back on to secure the **Ride Cymbal** in place.

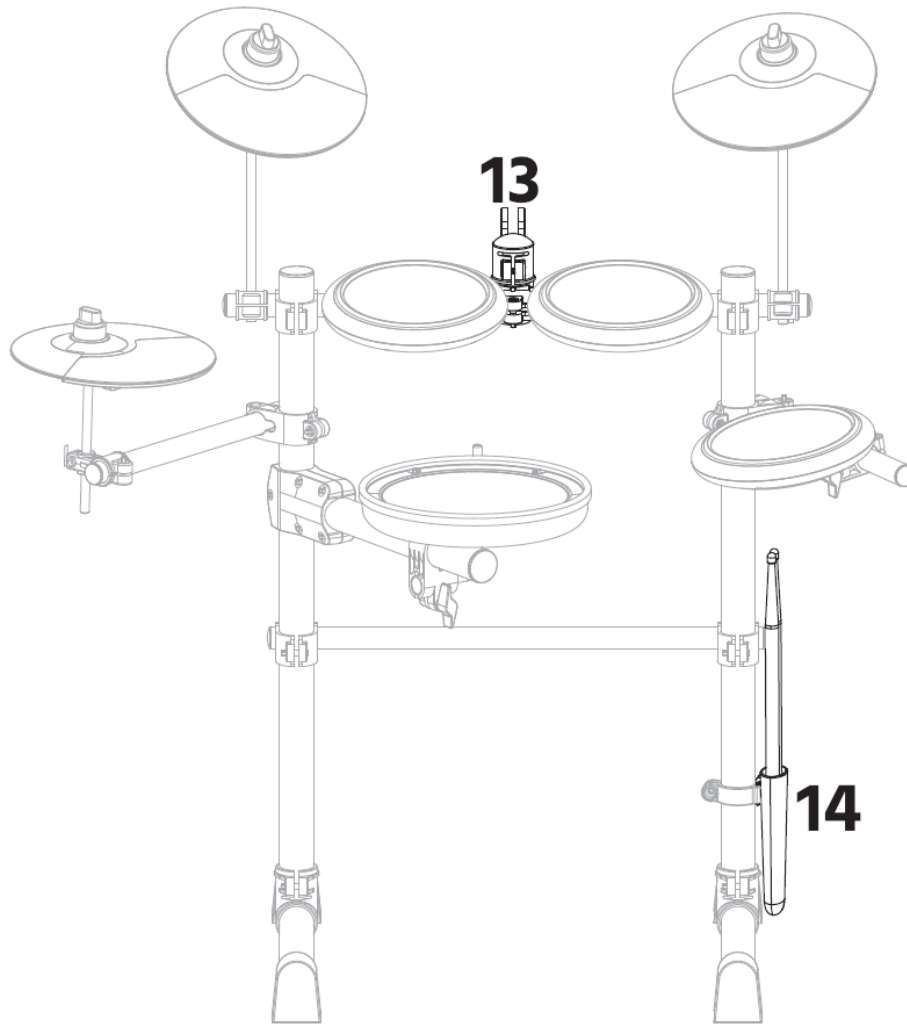

13. Attach the **Host Joint** to the **T1 T2 Rail**.
14. Attach the **Drum Sticks Holder** to the clamp on the right leg of the **Drum Rack** assembly, then insert the **Drum Sticks** into the **Drum Sticks Holder**.

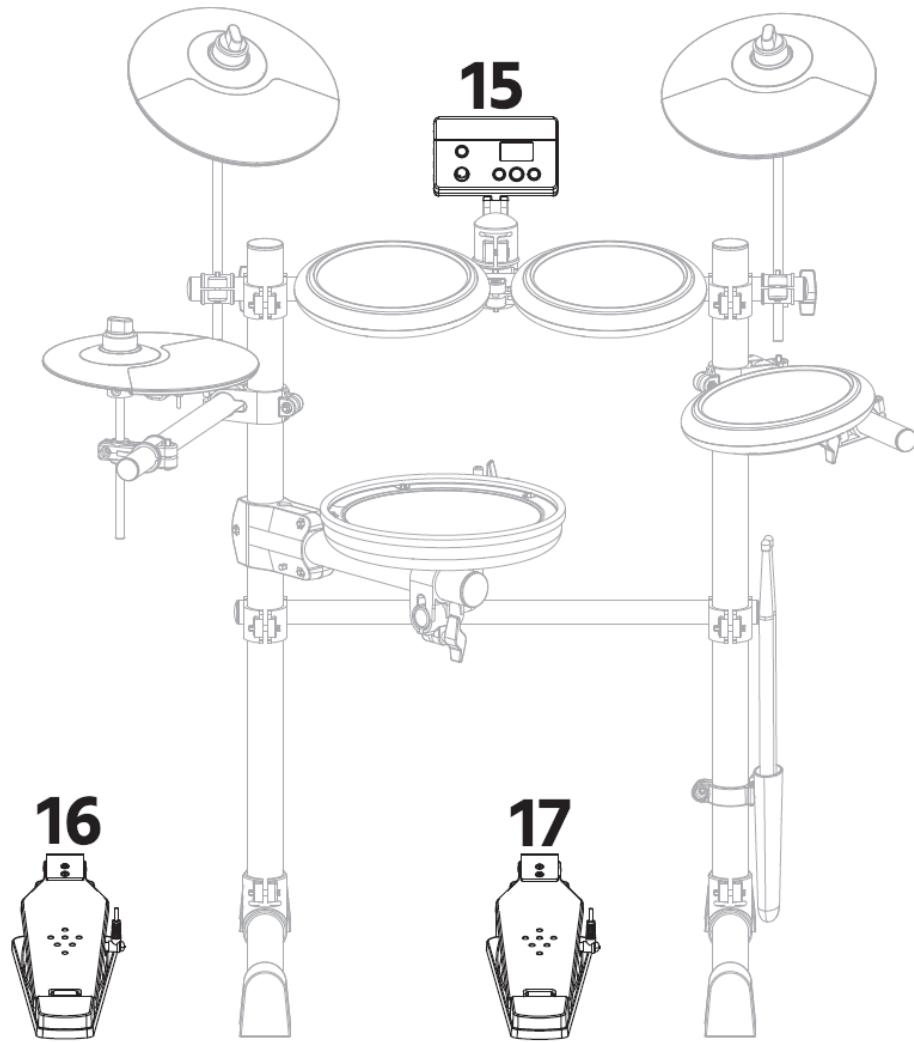

15. Attach the **Host Machine** to the **Host Joint**.

16. Place the **Hi-Hat Pedal** on the floor beneath the **Hi-Hat Cymbal**.

17. Place the **Bass Drum Pedal** on the floor near the center of the **Drum Rack** assembly.

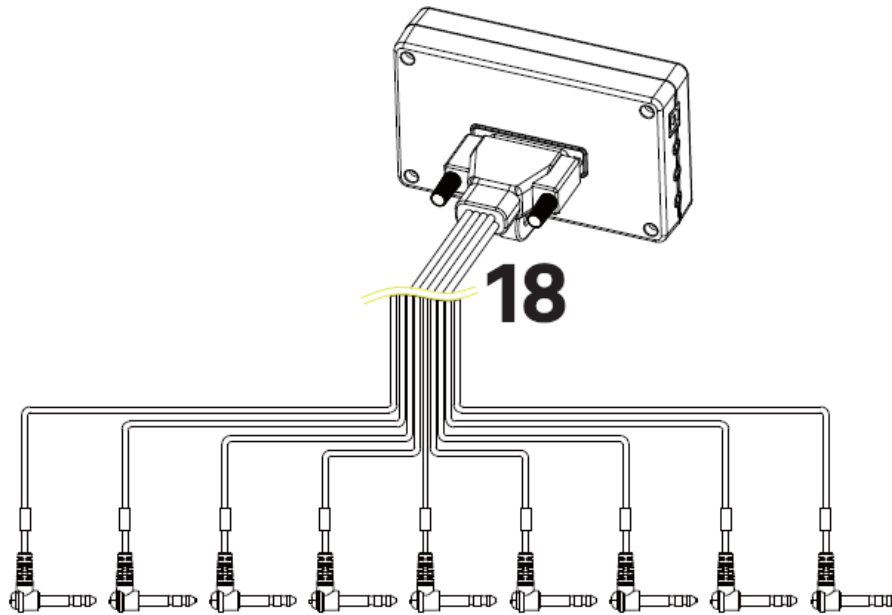

18. Plug the connector on the **Cable Assembly** into the connector on the back of the **Host Machine**, then tighten the two screws to secure it into place.

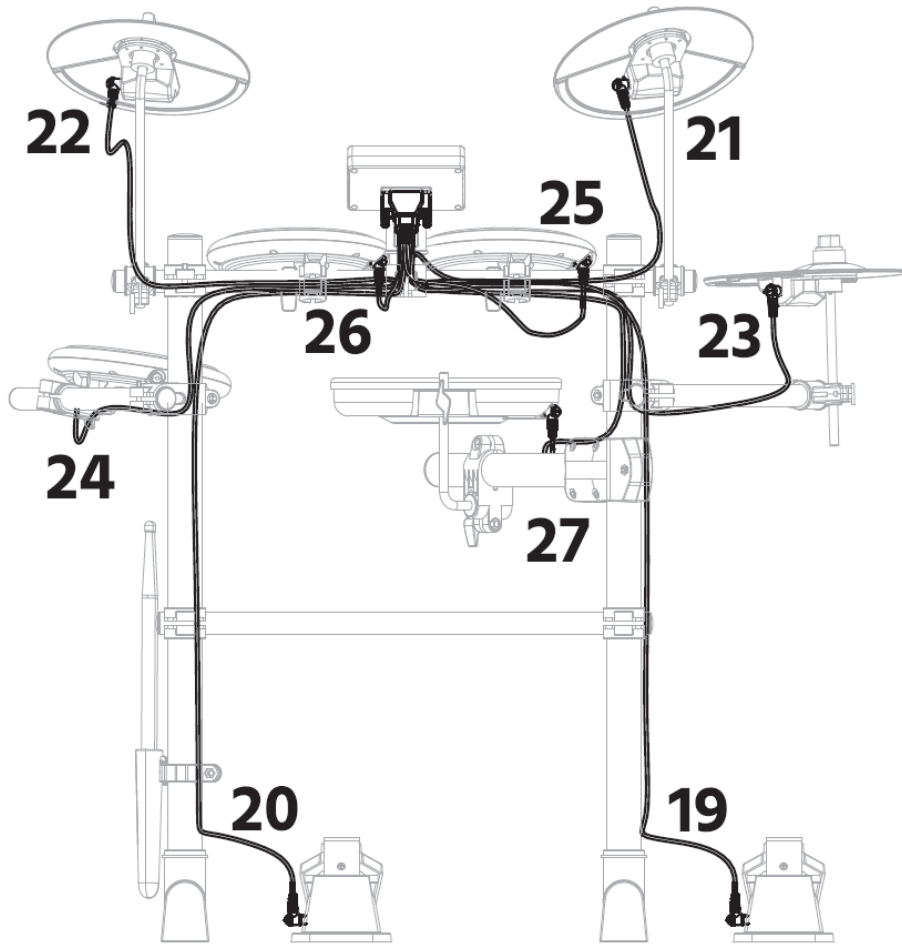

19. Locate the cable end with the **HHP** label and plug it into the **Hi-Hat Pedal**.
20. Locate the cable end with the **BD** label and plug it into the **Bass Drum Pedal**.
21. Locate the cable end with the **CR** label and plug it into the **Crash Cymbal**.
22. Locate the cable end with the **RD** label and plug it into the **Ride Cymbal**.
23. Locate the cable end with the **HH** label and plug it into the **Hi-Hat Cymbal**.
24. Locate the cable end with the **T3** label and plug it into the **Tom 3 pad**.
25. Locate the cable end with the **T1** label and plug it into the **Tom 1 pad**.
26. Locate the cable end with the **T2** label and plug it into the **Tom 2 pad**.
27. Locate the cable end with the **SD** label and plug it into the **Snare Drum pad**.

SETUP

Perform the following steps to prepare the drum kit for use. Ensure that all external equipment to be connected is powered off and disconnected from its power source.

1. If you want to use a Drum Amplifier, plug one end of a 3.5mm audio cable (not included) into the **OUTPUT** jack on the Host Machine, then plug the other end into the input on the amp. Alternatively, plug a pair of headphones (not included) into the **HEADPHONES** jack on the Host Machine.
2. If you want to use an external synthesizer or PC, plug one end of a USB cable (not included) into the **USB** jack on the host machine, then plug the other end into the synthesizer or an available USB port on your PC.
3. Plug the included AC Power Adapter into the **DC9V** jack on the Host Machine, then plug the adapter into a nearby AC power outlet.

BASIC OPERATION

- Momentarily press the **POWER** button to turn the system on. Press and hold the **POWER** button for several seconds to turn the system off.
- With the system powered on and the metronome off, press the **UP** and **DOWN** buttons to cycle through the twelve Drum Sounds. The **DISPLAY** will show which kit is selected.
- With the system powered on, momentarily press the **METRONOME** button to turn the metronome on into the default Tempo Mode.
- With the system powered on and the metronome on in Tempo Mode, press the **UP** button to increase the tempo or press the **DOWN** button to decrease the tempo.
- With the system powered on and the metronome on in Tempo Mode, press and hold the **METRONOME** button for three seconds to enter Beat Mode.
- With the system powered on and the metronome on in Beat Mode, use the **UP** and **DOWN** buttons to select one of the 8 beats. The **DISPLAY** will show which beat is selected.

- With the system powered on and the metronome on in Beat Mode, momentarily press the **METRONOME** button to exit Beat Mode and return to Tempo Mode.
- With the system powered on and the metronome on in Tempo Mode, momentarily press the **METRONOME** button to turn the metronome off.

ADVANCED OPERATION

Pedal Adjust

With variations in temperature and humidity, the sensitivity of the pedals can vary. Perform the following steps to recalibrate the pedal sensitivity.

1. With the system powered off, simultaneously press and hold the **POWER** and **METRONOME** buttons to enter Pedal Adjust Mode.
2. With the **DISPLAY** showing **HHF**, stomp on the **Hi-Hat Pedal** and hold it down.
3. The **METRONOME** button will illuminate green and orange while the system is automatically calibrating the pedal sensitivity. When the calibration is complete, the **METRONOME** button will turn red and the system will exit Pedal Adjust Mode. You may now release the pedal.

Software Update

In the event that the system software is updated, perform the following steps to update the system software.

1. Download the software update on your PC and place the update file where directed.
2. Using a USB cable (not included), plug one end into the **USB** jack on the Host Machine, then plug the other end into an available USB port on your PC.
3. With the system powered off, press and hold the **POWER** and **DOWN** buttons to enter Software Update Mode. The **DISPLAY** will show **UPG**. Follow the instructions for the update.

Factory Reset

With the system powered off, press and hold the **POWER** and **UP** buttons to reset the system to its factory default settings. The **DISPLAY** will show **CLr**.

System Version

With the system powered on, press and hold the **METRONOME** button for 3 seconds. The **DISPLAY** will show the current software version number.

BASIC PLAY

The system plays the same as a physical drum kit and allows you to create the same sounds and rhythms using the same methods as with a physical kit.

Hi-Hat and Hi-Hat Pedal

- Press down on the **Hi-Hat Pedal** and strike the **Hi-Hat Cymbal** to make short, high pitched sounds.
- Strike the **Hi-Hat Cymbal** without holding down the pedal to make longer, lower pitched sounds.
- Stomp on the **Hi-Hat Pedal** without striking the **Hi-Hat Cymbal** to make different sounds. The strength and speed of your stomp affects the sound.

Bass Drum Pedal

You can make different Bass Drum sounds depending on how strong and how fast you stomp on the **Bass Drum Pedal**.

Ride Cymbal

- The **Ride Cymbal** supports **Bow Shots** and **Bell Shots**, as depicted in the images below.

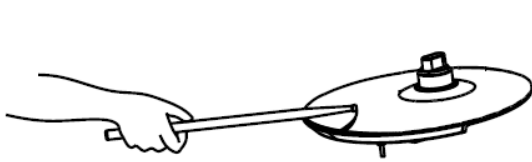

Bow Shot



Bell Shot

- Pinch the edge of the **Ride Cymbal** in the black area in the image below to mute the cymbal.



Pinch to Mute

Snare Drum

- The **Snare Drum** allows you to make a **Cross Stick** sound.

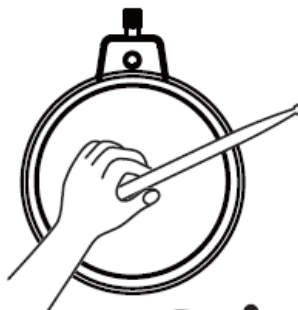

Cross Stick

MIDI FORMAT LIST

Function		Transmitted	Recognized	Remarks
Basic Channel	Default	10	1~8 & 10~16	
	Changed	x	x	
Mode	Default	x	Mode 3	
	Messages	x	x	
	Altered	*****	*****	
Note Number		0~127	0~127	
	True Voice	*****	0~127	
Velocity	Note ON	0~127	0~127	
	Note OFF	x	0~127	
After Touch	Keys	x	x	
	Channels	x	x	
Pitch Bend		x	0	
Control Change	0	x	0	Bank Select
	1	x	0	Modulation
	4	x	0	Foot Control
	5	x	0	Portamento Time
	6	x	0	Data Entry
	7	x	0	Volume
	10	x	0	Pan
	11	x	0	Expression
	64	x	0	Sustain Pedal
	65	x	0	Portamento On/Off
	66	x	0	Sostenuto Pedal
	67	x	0	Soft Pedal
	71	x	0	Resonance
	72	x	0	Release Time
	73	x	0	Attack Time
74	x	0	Cut Off	

Function		Transmitted	Recognized	Remarks
Control Change (continued)	80	x	O	Reverb Program
	81	x	O	Chorus Program
	90	x	O	Reverb Level
	91	x	O	Chorus Level
	120	x	O	All Sounds OFF
	121	x	O	Reset All Controllers*
	123	x	O	All Notes OFF*
Program Change		x	O	
System Exclusive		x	O	
System Common	Song Position	x	x	
	Song Select	x	x	
	Tune	x	x	
System Real Time	Clock	x	x	
	Commands	x	x	
Aux Message	Local ON/OFF	x	x	
	All Notes OFF	x	x	
	Active Sense	O	x	
	Reset	x	x	

Mode 1: Omni On, Poly

Mode 2: Omni On, Mono

O=Yes, x=No

Mode 3: Omni Off, Poly

Mode 4: Omni Off, Mono

Notes: *Except 9, 10 Channel

TECHNICAL SUPPORT

Monoprice is pleased to provide free, live, online technical support to assist you with any questions you may have about installation, setup, troubleshooting, or product recommendations. If you ever need assistance with your new product, please come online to talk to one of our friendly and knowledgeable Tech Support Associates. Technical support is available through the online chat button on our website www.monoprice.com or through email by sending a message to tech@monoprice.com. Check the website for support times and links.

SPECIFICATIONS

Model	625921
Active Elements	3 Cymbals (Hi-Hat, Crash, Ride), 3 Toms, 1 Snare, 2 Pedals (Hi-Hat, Bass Drum)
Metronome Tempo	40 ~ 240 bpm
Metronome Beats	1 ~ 8
Input Power	9 VDC, 300mA

REGULATORY COMPLIANCE

Notice for FCC



This device complies with Part 15 of the FCC rules. Operation is subject to the following two conditions: (1) this device may not cause harmful interference, and (2) this device must accept any interference received, including interference that may cause undesired operation.

Modifying the equipment without Monoprice's authorization may result in the equipment no longer complying with FCC requirements for Class B digital devices. In that event, your right to use the equipment may be limited by FCC regulations, and you may be required to correct any interference to radio or television communications at your own expense.

This equipment has been tested and found to comply with the limits for a Class B digital device, pursuant to Part 15 of the FCC Rules. These limits are designed to provide reasonable protection against harmful interference in a residential installation. This equipment generates, uses and can radiate radio frequency energy and, if not installed and used in accordance with the instructions, may cause harmful interference to radio communications. However, there is no guarantee that interference will not occur in a particular installation. If this equipment does cause harmful interference to radio or television reception, which can be determined by turning the equipment off and on, the user is encouraged to try to correct the interference by one or more of the following measures:

- Reorient or relocate the receiving antenna.
- Increase the separation between the equipment and receiver.
- Connect the equipment into an outlet on a circuit different from that to which the receiver is connected.
- Consult the dealer or an experienced radio/TV technician for help.

Notice for Industry Canada

This Class B digital apparatus complies with Canadian ICES-003.

Cet appareil numérique de la classe B est conforme à la norme NMB-003 du Canada.

Monoprice™, Stage Right™, the Stage Right logo, and all Monoprice logos are trademarks of Monoprice Inc.